

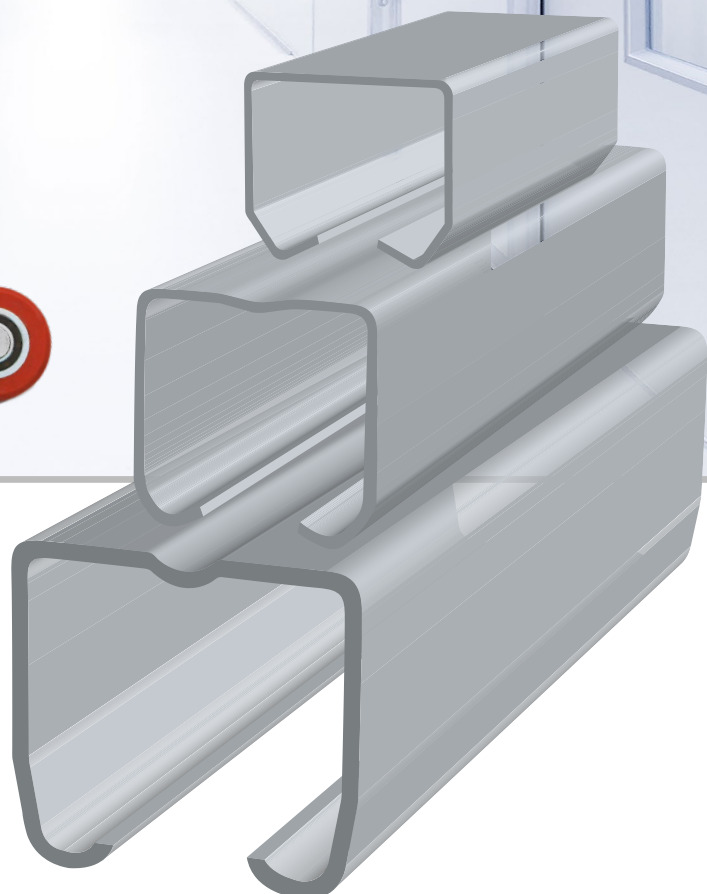

Industrial Stainless Series

Stainless steel sliding hardware



Overview...

Alongside our proven ranges of industrial and architectural systems **Runners** has developed a range of Stainless Steel systems built from high grade 316 stainless steel ideal for hygiene areas, harsh weather conditions and salt water environments.

These systems include a comprehensive range of tracks, channels and components which are straightforward to install, built to last and offer great value for money.

We recognise that customer service is of utmost importance in today's busy commercial market. To this end **Runners** has an ongoing programme of continual improvement based on customer feedback. We carry large stocks to enable us to rapidly respond to customer needs.

For special requirements and advice, our in-house design team is available to help. Whatever your application, there's a **Runners** system that provides the solution.

Runners Industrial is the choice where durability, strength and versatility really matter.

Typical Applications:

Coastal locations	Overhead runways	Hospitals
Marine buildings	Abattoirs	Industrial doors
Factory dividers	Food processing areas	

Engineered to last a lifetime

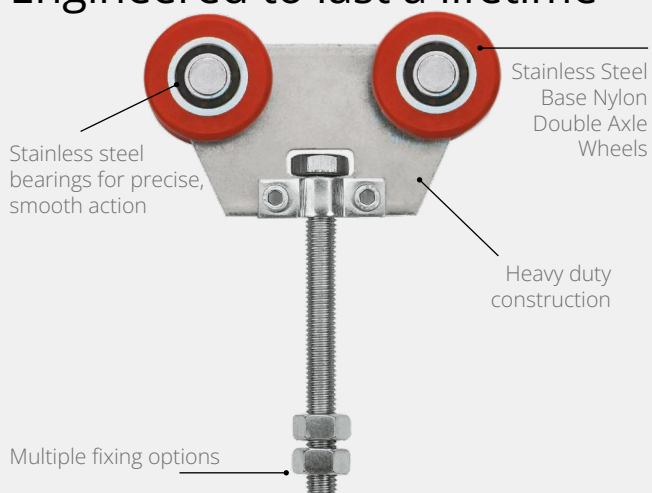

TECHNICAL SUPPORT

Our team of experts are only a phone call away and can offer technical help and advice on system selection, installation and maintenance.

SPARES

Runners carry a full range of spares for all our sliding systems. All parts are available for immediate dispatch or collection from our trade counter.





Introduction

Stainless Steel Sliding Hardware

Our comprehensive range of stainless track and fittings is ideally suited to applications exposed to harsh weather conditions, including marine, agriculture and the food processing industry.

All components are manufactured from high quality **316 grade stainless steel** suitable for salt water conditions.

series **75** maximum capacity
75kg per panel

Stainless steel sliding hardware for door panels up to 75kg.

This product is ideal for lightweight doors or overhead runway applications.

A4/316 grade Stainless steel.

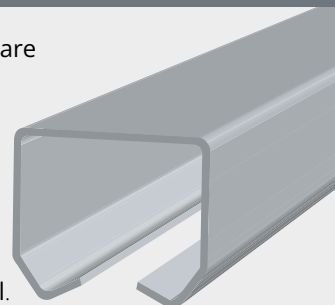

series **300** maximum capacity
300kg per panel

Stainless steel sliding hardware for door panels up to 300kg.

The series 300 is frequently used for large external doors on commercial and agricultural buildings.

A4/316 grade Stainless steel.

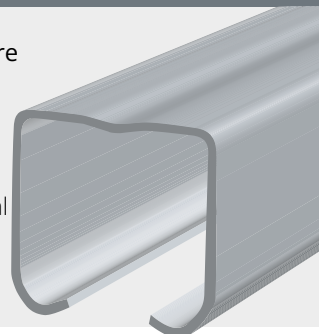

series **450** maximum capacity
450kg per panel

Stainless steel sliding hardware for doors up to 450kg.

Our heavy duty range the series 450 is the answer to those heavy weight applications.

A2/304 or A4/316 grade Stainless steel.

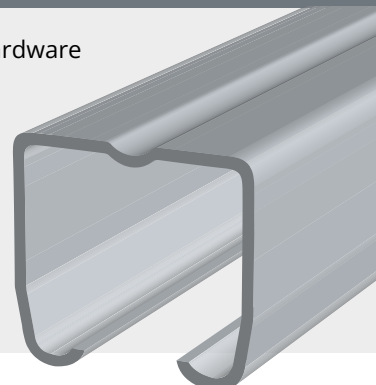

Stainless steel hardware sliding doors upto 75kg

Our comprehensive range of stainless track and fittings is ideally suited to applications exposed to harsh weather conditions, including marine, agriculture and the food processing industry.

All components, track and channel are manufactured from A4/316 grade Stainless steel.

Tracks & Guides

Stainless Steel Series 75

105-4760

Stainless steel
top track.

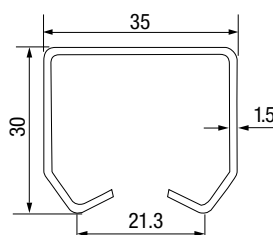

Length	Part No.
3 metre	100-4760-3

- The Stainless Steel Top Track is manufactured with drilled holes.
- Two hangers must be used for stability and maximum weight capacity.

Stainless Steel Series 75 Curved upper track

105-47351

Stainless steel
top track.

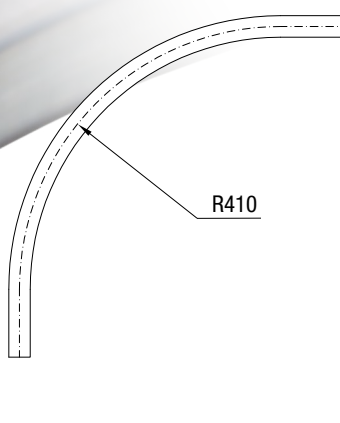

Length	Part No.
3 metre	100-47351-3

- The Stainless Steel Top Track is manufactured with drilled holes.
- Two hangers must be used for stability and maximum weight capacity.

Stainless Steel Top Track Joint

110-47311

Component used for
joining two tracks

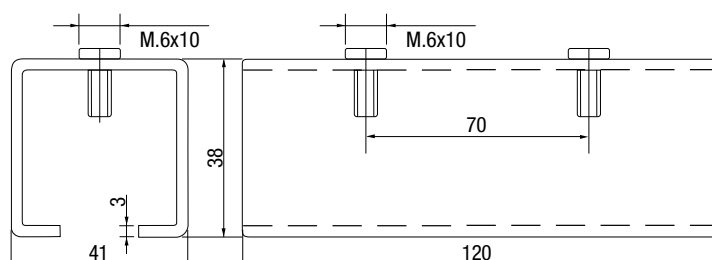

Tracks & Guides

Stainless Steel Double Wheel Hanger

105-4641

This double wheel hanger has 4 nylon wheels. The central bolt can be removed for easy maintenance or repair.

Weight capacity is 75kg per pair.

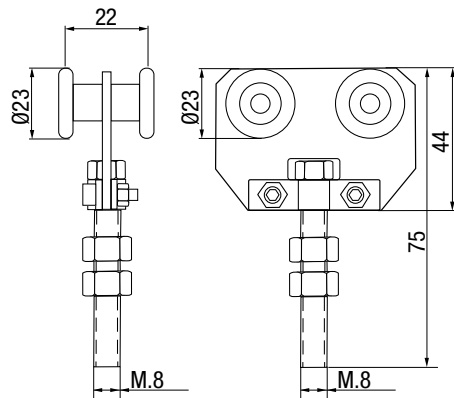

Stainless Steel Track Stop

105-47312

Stainless steel track stop which can be locked at any position along the track. The rollers buffer against the rubber stop.

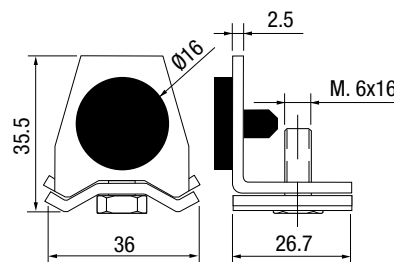

Stainless Steel Bottom Guide Channel

100-486-3

For a better operation of the door, it is recommended the use of the bottom guides.

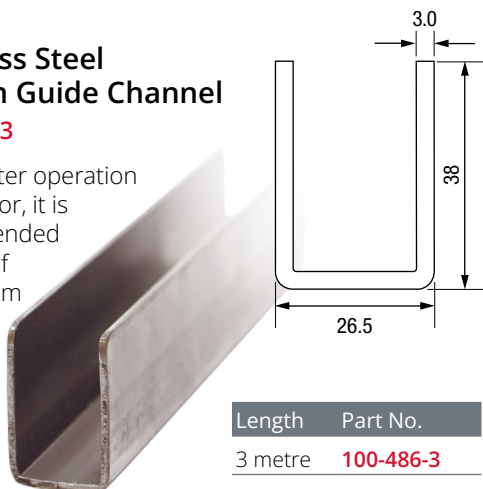

Stainless Steel Curved Bottom Guide Channel

100-48120-3

For a better operation of the door, it is recommended the use of the bottom guides.

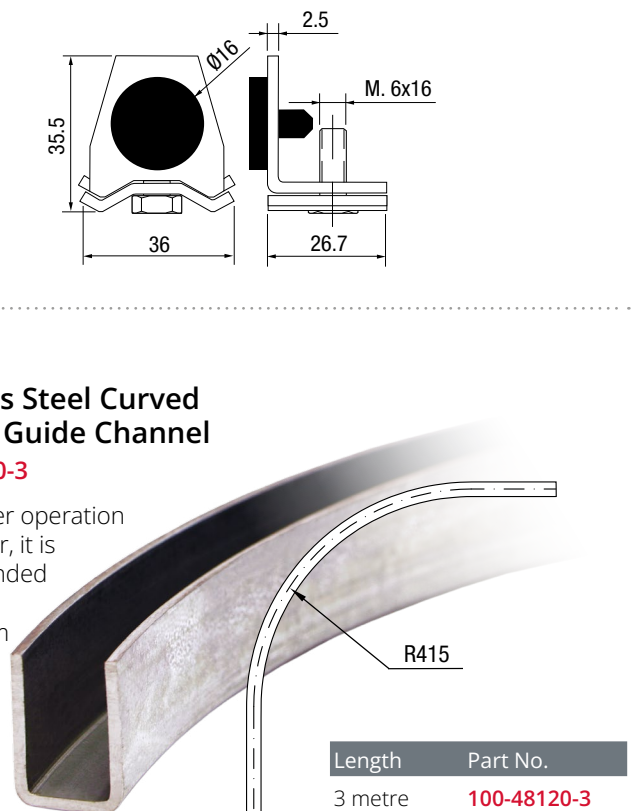

Lower Nylon Guide

100-5006

Ideal for wooden doors simply machine a groove in the bottom of the door.

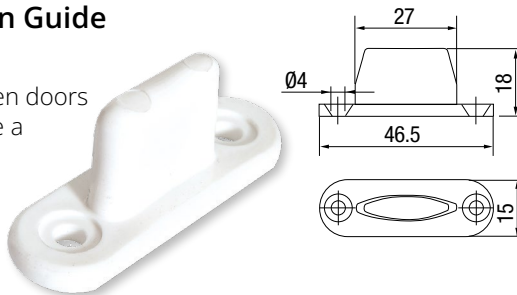

Stainless Steel Bottom Guide Roller

100-791

Stainless steel bottom guide roller with M16 threaded pin. To be used with 100-486 guide channel.

For a better operation of the door, it is recommended the use of the bottom guides.

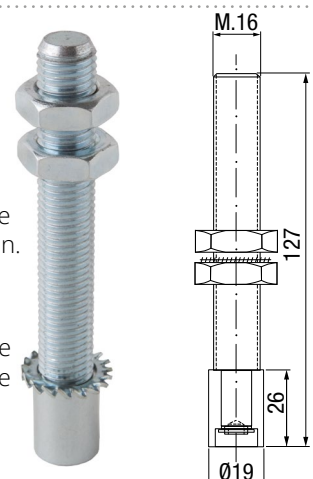



series 75

Stainless steel hardware sliding doors upto 75kg

Our comprehensive range of stainless track and fittings is ideally suited to applications exposed to harsh weather conditions, including marine, agriculture and the food processing industry. All components, track and channel are manufactured from A4/316 grade Stainless steel.



series 300

Stainless steel hardware
for sliding doors up to 300kg

Our comprehensive range of stainless track and fittings is ideally suited to applications exposed to harsh weather conditions, including marine, agriculture and the food processing industry. All components, track and channel are manufactured from A4/316 grade Stainless steel.

Tracks & Guides

Stainless Steel Top Track

110-472-3

The stainless steel top track for sliding doors allows for the sliding door movement.

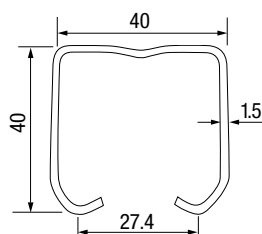
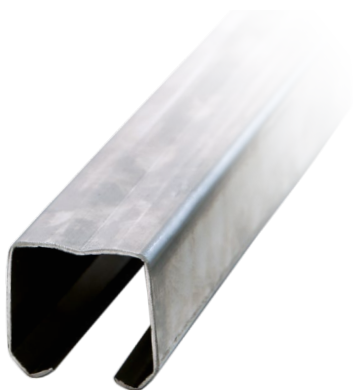

Length	Part No.
3 metre	110-472-3

■ Two hangers have to be used for stability and maximum weight capacity.

Stainless Steel Curved Top Track

110-4771-3

The stainless steel top track for sliding doors allows for the sliding door movement.

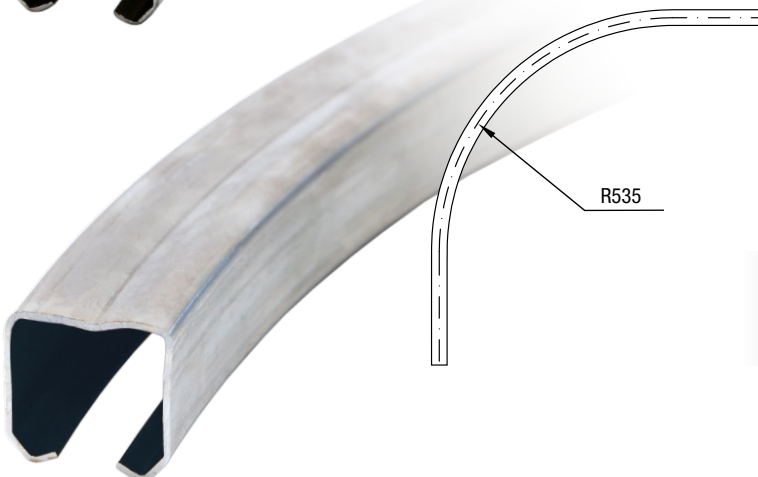

Length	Part No.
3 metre	110-4771-3

■ Two hangers have to be used for stability and maximum weight capacity.

Stainless Steel Top Track Joint

110-47811

Component used for joining two tracks

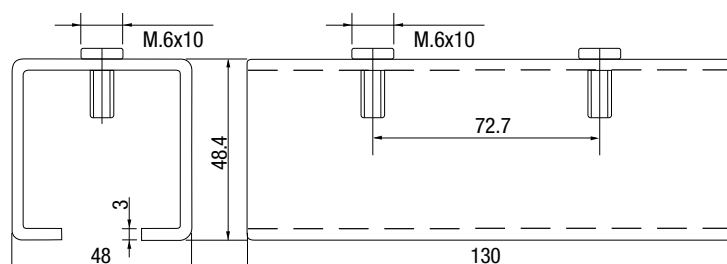

Tracks & Guides

Stainless Steel Adjustable Top Track Bracket

110-47860

Soffit bracket with height adjustable thread.
We recommend to install rail supports every 500mm.

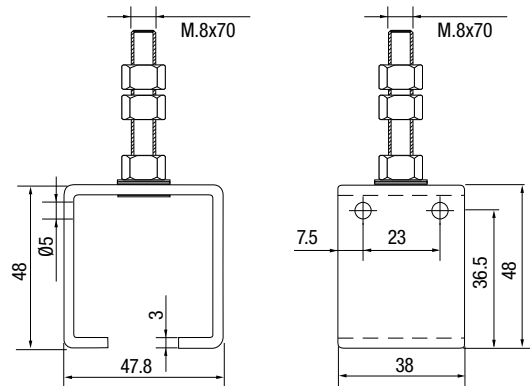
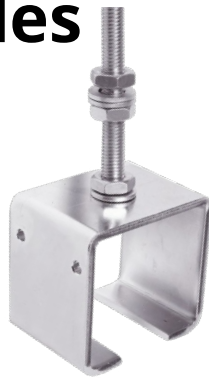

Stainless Steel Top Track Bracket for face fixing

110-47850

Face fix wall mounted bracket. We recommend to install rail supports every 500mm.

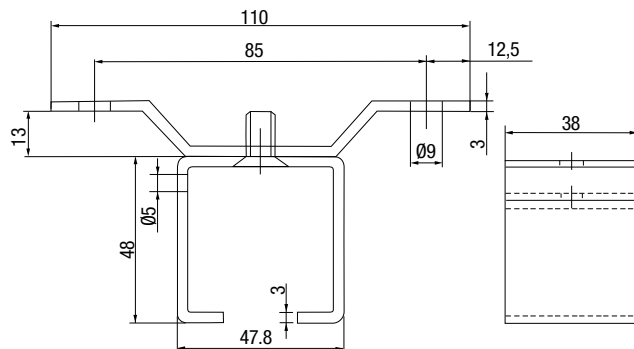

Stainless Steel Top Track Bracket for Ceiling Attachment

110-47870

Soffit fix bracket.
We recommend to install rail supports every 500mm.

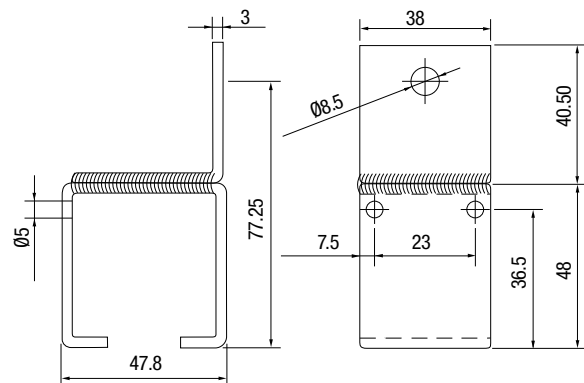

Stainless Steel Top Track Bracket for Welding

110-47830

This bracket is designed to be welded in position.
We recommend to install rail supports every 500mm.

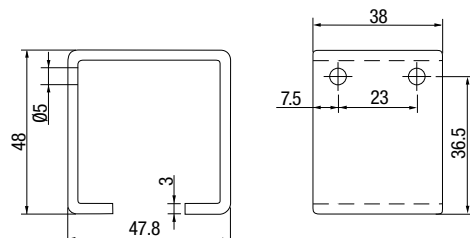

Stainless Steel Track Stop

110-47812

Stainless steel track stop can be fixed at any position along the track.
Rubber buffer cushions impact from the hanger.

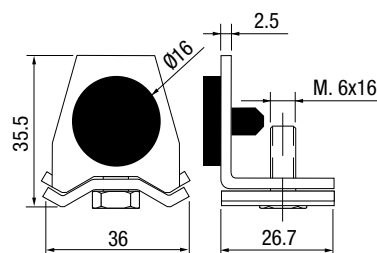

Tracks & Guides

Stainless Steel Single Axle Wheel Hanger

110-468

Weight capacity is 150kg per pair.

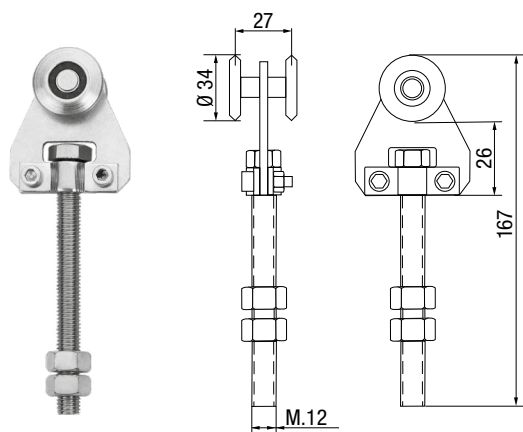

Stainless Steel Double Axle Wheel Hanger Series 300

110-469

Weight capacity is 300kg per pair.

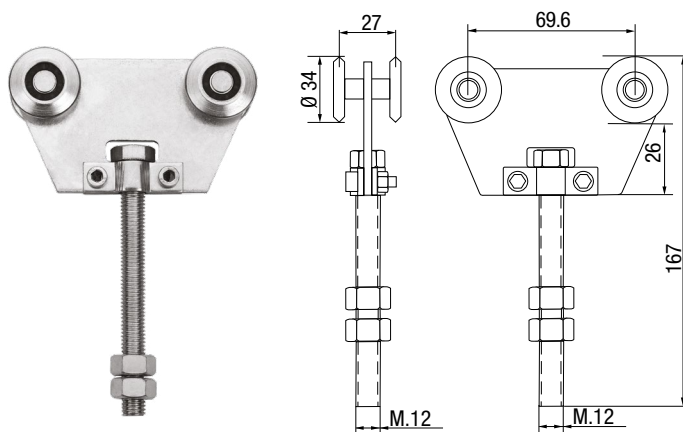

Stainless Steel Bottom Guide Channel

100-486-3

For a better operation of the door, it is recommended the use of the bottom guides.

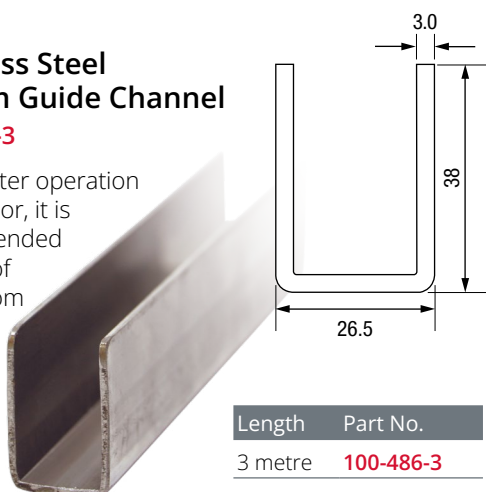

Stainless Steel Curved Bottom Guide Channel

100-4810-3

For a better operation of the door, it is recommended the use of the bottom guides.

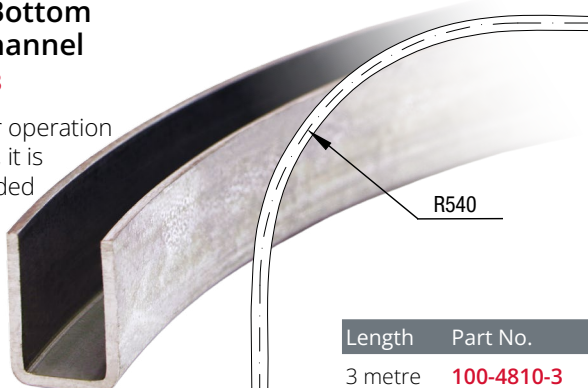

Stainless Steel Bottom Guide Roller

100-791

Stainless steel bottom guide roller with M16 threaded pin. To be used with 100-486 guide channel.

For a better operation of the door, it is recommended the use of the bottom guides.

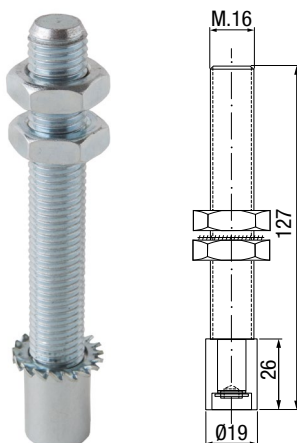

■ TECHNICAL SUPPORT

Our team of experts are only a phone call away and can offer technical help and advice on system selection, installation and maintenance.

■ SPARES

Runners carry a full range of spares for all our sliding systems. All parts are available for immediate dispatch or collection from our trade counter.

stainless series **300**

series **300**

Stainless steel hardware
for sliding doors up to 300kg

Our comprehensive range of stainless track and fittings is ideally suited to applications exposed to harsh weather conditions, including marine, agriculture and the food processing industry. All components, track and channel are manufactured from A4/316 grade Stainless steel.

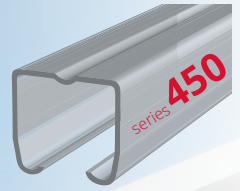
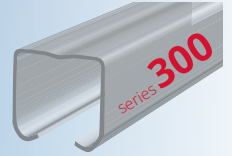

Stainless steel hardware for sliding doors up to 450kg

Our comprehensive range of stainless track and fittings is ideally suited to applications exposed to harsh weather conditions, including marine, agriculture and the food processing industry. All components are manufactured from A2/304 grade Stainless steel. Tracks are manufactured from A2/304 and A4/316 grade Stainless steel.

Tracks & Guides

Stainless Steel Top Track

115-485
115-48516

Two hangers have to be used for stability and maximum weight capacity.

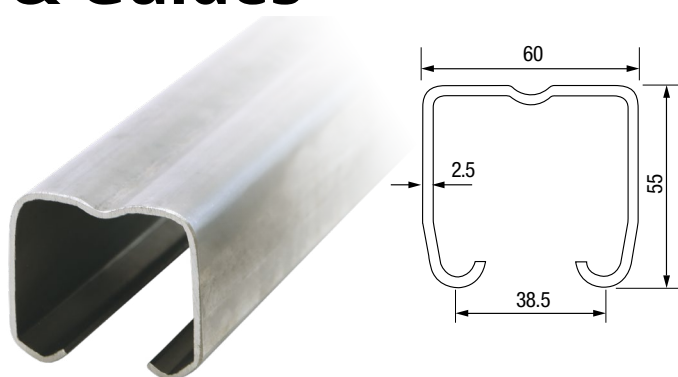

Length	Part No.	Grade
3 metre	105-485	A2/304
3 metre	105-48516	A4/316

- The Stainless Steel Top Track is manufactured with drilled holes.
- Two hangers must be used for stability and maximum weight capacity.

Stainless Steel Curved Top Track

115-4804
115-4806

Stainless steel top track.



Length	Part No.	Grade
3 metre	105-4804	A2/304
3 metre	105-4806	A4/316

- Stainless Steel Series 450 Top Tracks are manufactured in stainless steel. A2/304 is our standard stainless steel grade.
- For Marine or coastal applications, please use A4/316 grade.

Stainless Steel Top Track Joint

110-47911

Component used for joining two tracks.

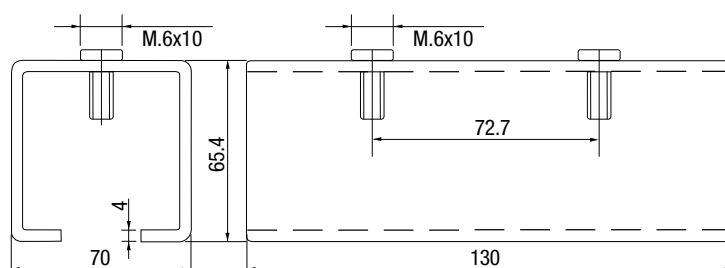

Tracks & Guides

Stainless Steel Top Track Bracket for Welding

115-47930

This bracket is designed to be welded in position.

We recommend to install rail supports every 500mm.

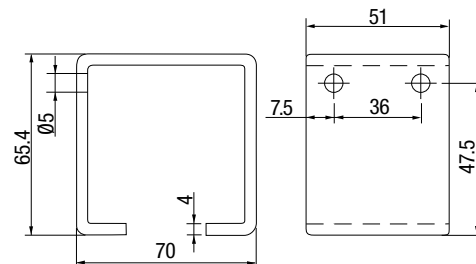

Stainless Steel Top Track Bracket for face fixing

115-47950

Face fix wall mounted bracket.

We recommend to install rail supports every 500mm.

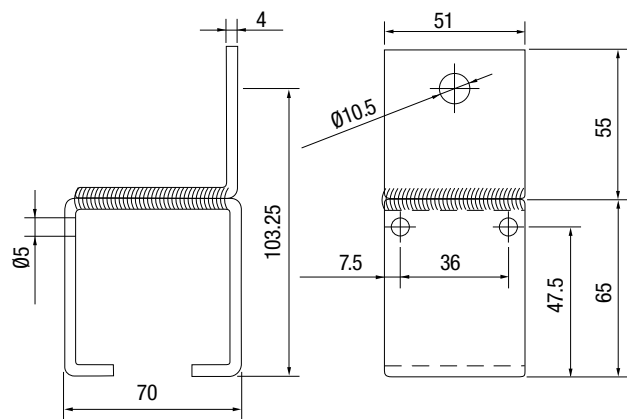

Stainless Steel Adjustable Top Track Bracket

115-47960

Soffit fix bracket with height adjustable thread.

We recommend to install rail supports every 500mm.

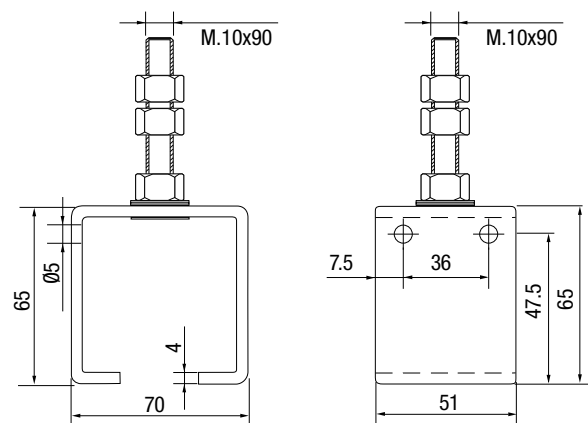

Stainless Steel Bottom Guide Roller

100-791

Stainless steel bottom guide roller with M16 threaded pin. To be used with 100-486 guide channel.

For a better operation of the door, it is recommended the use of the bottom guides.

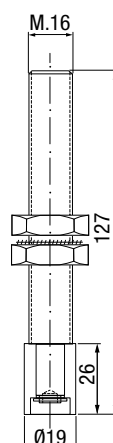

■ TECHNICAL SUPPORT

Our team of experts are only a phone call away and can offer technical help and advice on system selection, installation and maintenance.

■ SPARES

Runners carry a full range of spares for all our sliding systems. All parts are available for immediate dispatch or collection from our trade counter.

Tracks & Guides

Stainless Steel Nylon Single Axle Wheel Hanger

115-483

Weight capacity is
240kg per pair.

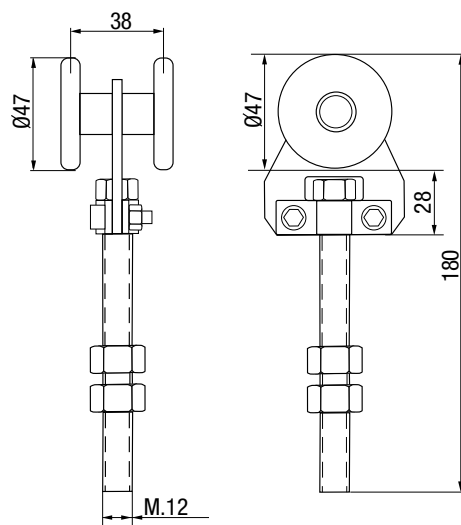
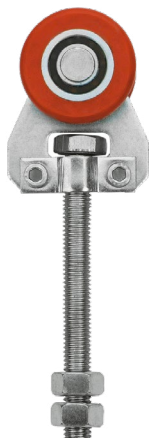

Stainless Steel Nylon Double Axle Wheel Hanger

115-484

Weight capacity is
450kg per pair.

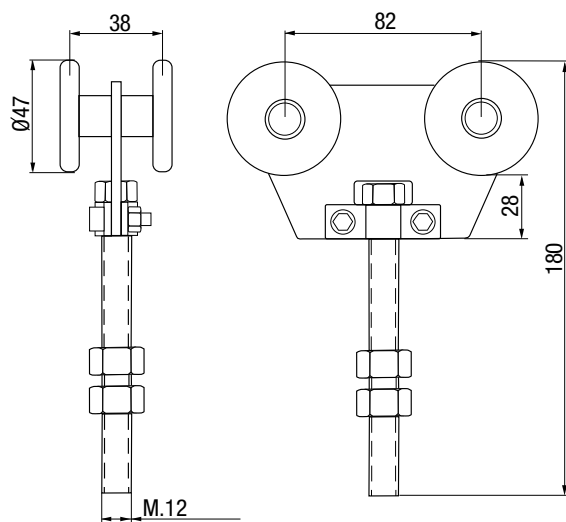
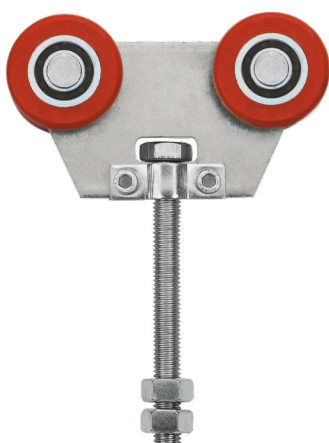

Stainless Steel Bottom Guide Channel

100-486-3

For a better operation
of the door, it is
recommended the
use of the
bottom
guides.

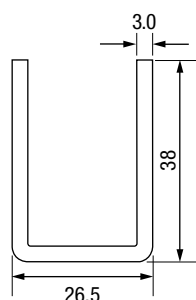

Length	Part No.
3 metre	100-486-3

Stainless Steel Curved Bottom Guide Channel

100-48110-3

For a better operation
of the door, it is
recommended
the use of
the bottom
guides.



Length	Part No.
3 metre	100-4810-3

stainless series **450**

series **450**

Stainless steel hardware for sliding doors up to 450kg

Our comprehensive range of stainless track and fittings is ideally suited to applications exposed to harsh weather conditions, including marine, agriculture and the food processing industry. All components are manufactured from A2/304 grade Stainless steel. Tracks are manufactured from A2/304 and A4/316 grade Stainless steel.

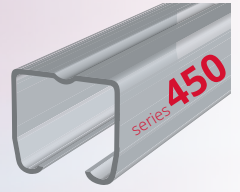

Keeping your trailers in action – sliding solutions for curtain siders.



runners
SLIDING SYSTEMS



Runners Sliding Systems
Signal Hill
Lenborough Road
Gawcott
Buckingham
MK18 4BU

Tel: 00 44 (0)1280 822288
Fax: 00 44 (0)1280 813024
Email: sales@runners-sales.com
Web: www.runners-uk.com

Other products available from Runners Sliding Systems

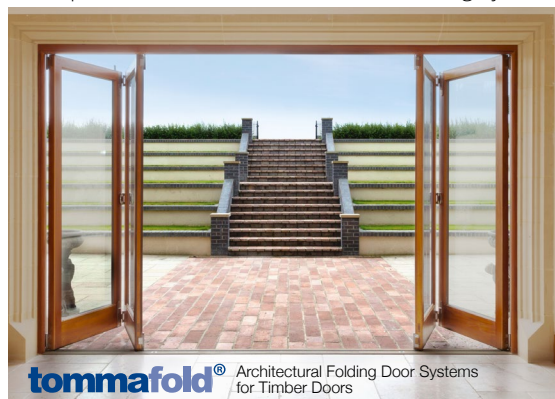

tommafold® Architectural Folding Door Systems
for Timber Doors



multirail
& **SMART SPRAY**
Overhead Runway Systems



trakkit
Sliding Door Kits