

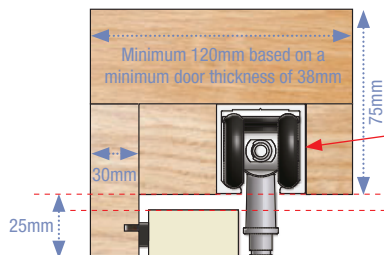

Please read these instructions fully before installation.

1

Outward Opening



Inward Opening

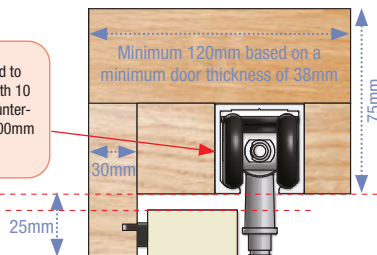

Track to be fixed to suitable beam with 10 gauge (5mm) counter-sunk screws at 300mm intervals

Opening height (OH)
Door height = Opening height less 15mm

Hinge Handle set

Hinge set

NOTE:
Dimensions shown in blue for joinery section sizes are suggestions only

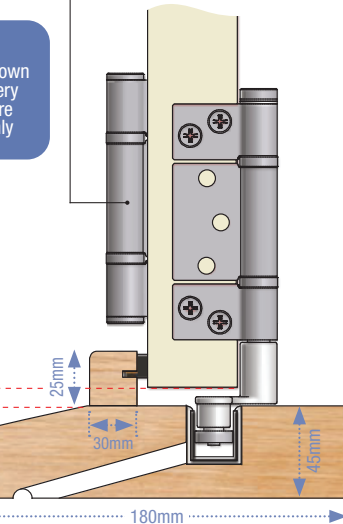
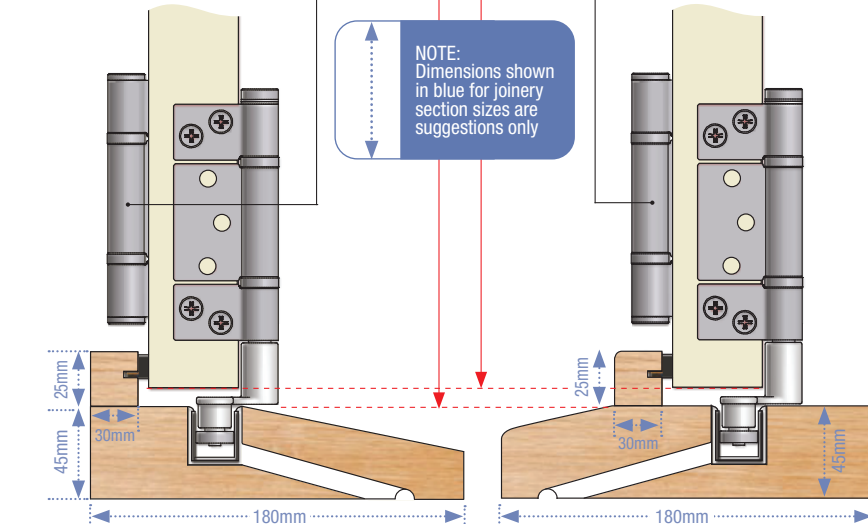

Outward/Inward Opening Head Detail

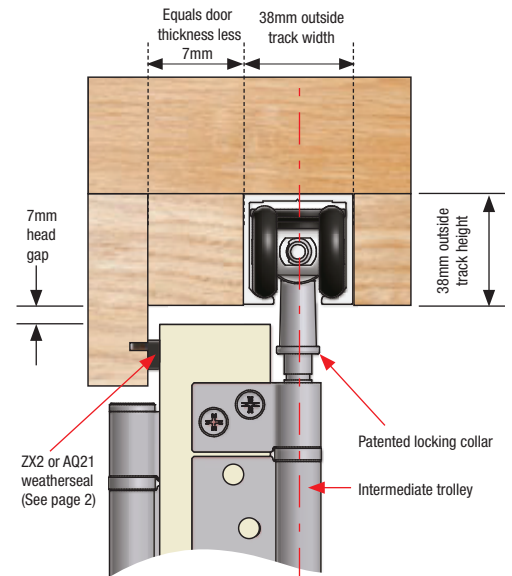

Outward Opening Sill Detail

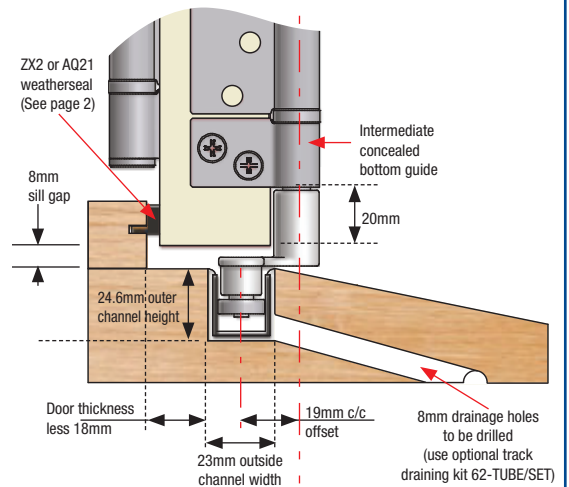

Inward Opening Sill Detail

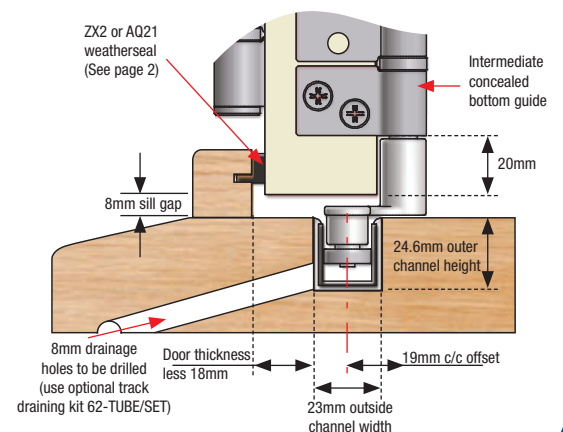

2a

Calculating door leaf sizes.

1

CONFIGURATION

Decide on a configuration layout (see enclosed configuration leaflet).



2

CLEARANCES

With all configurations you need to allow for the following clearances:



- Jamb to door : - 6mm (inside rebate).
See jamb detail drawing below.
- Panel to panel: - 4mm
- Bottom of door to sill: - 8mm
- Top of door to head: - 7mm

Jamb detail

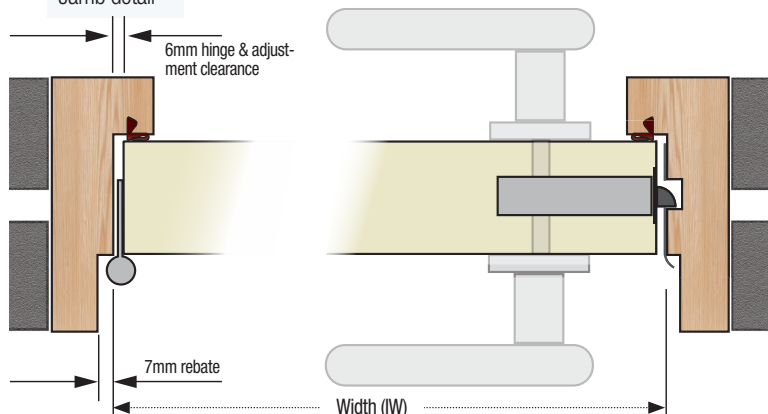
**Door Width Calculation formula:** $IW - 12 - (4 \times (N - 1))$

Calculation key:

IW = Inside frame width (measuring across inside stepped rebate)**N** = Number of doors**WORKED EXAMPLE**

3 right & 1 left configuration:

Inside frame opening size: **4000mm wide x 2150mm high**

$$\text{Door widths} = \frac{4000 - 12 - (4 \times (4 - 1))}{4} = 4 \text{ panels } 994\text{mm wide}$$

Door heights =
 $2150 \text{ (aperture height)} - 7 \text{ (door top to head)} - 8 \text{ (door bottom to sill)}$
 = door height of 2135mm

2b

Fitting of End Carrier and Meeting Carrier Sets

It is recommended that End Carrier or Meeting Carrier Sets are recessed flush with door edge as shown below.

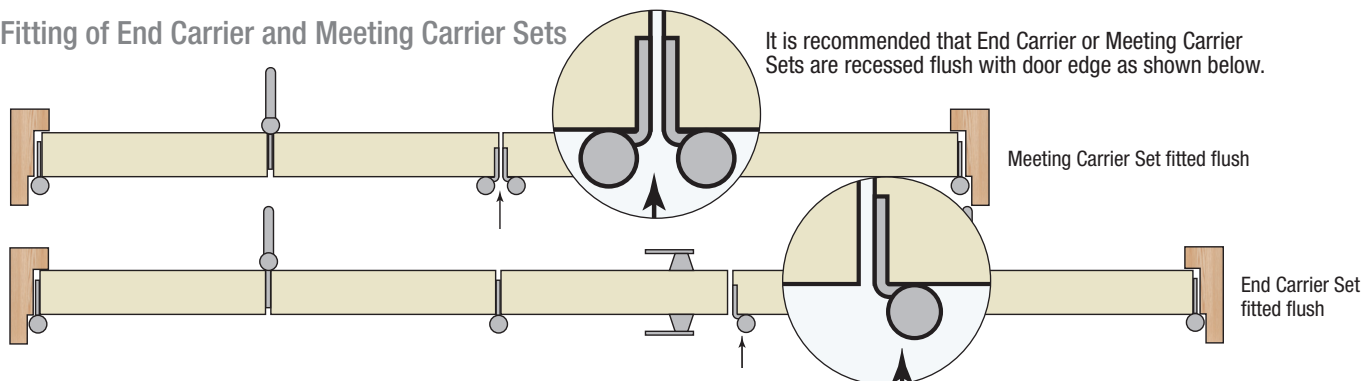

3

Prepare doors and frame for weatherseals (figs. 1, 2, 3) Flush bolts (fig. 4/5) should be recessed using optional router cutter (part no. 60-RT002).

Perimeter Seal

fig 1

**Panel to Panel Seal**

fig 2

**Meeting Panel Seal**

fig 3

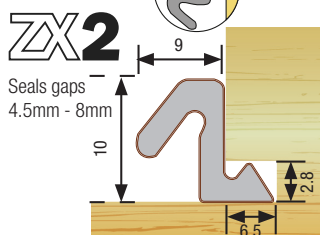

Standard flush bolt for outward opening doors

fig 4

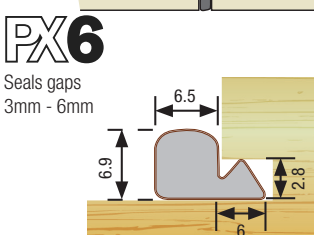
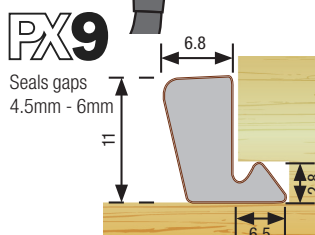
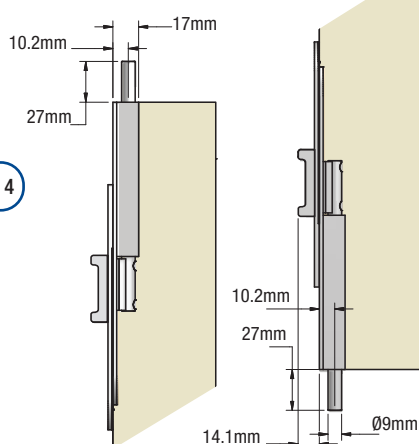

Cranked flush bolt for inward opening doors

fig 5

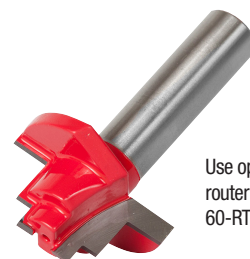
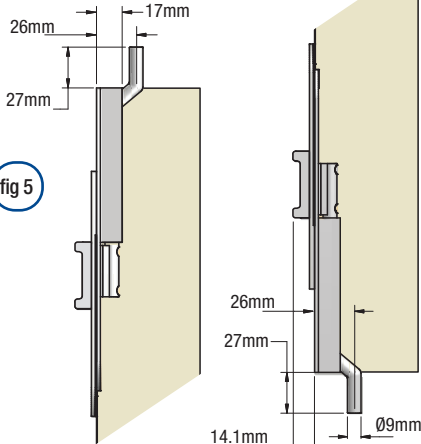
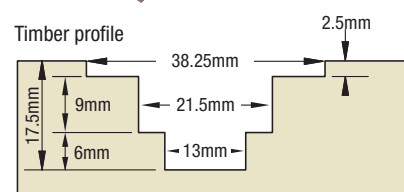
Use optional
router cutter
60-RT002

4

Pre-drill holes on door panels using optional hinge jig (part no. 60-DJ100).

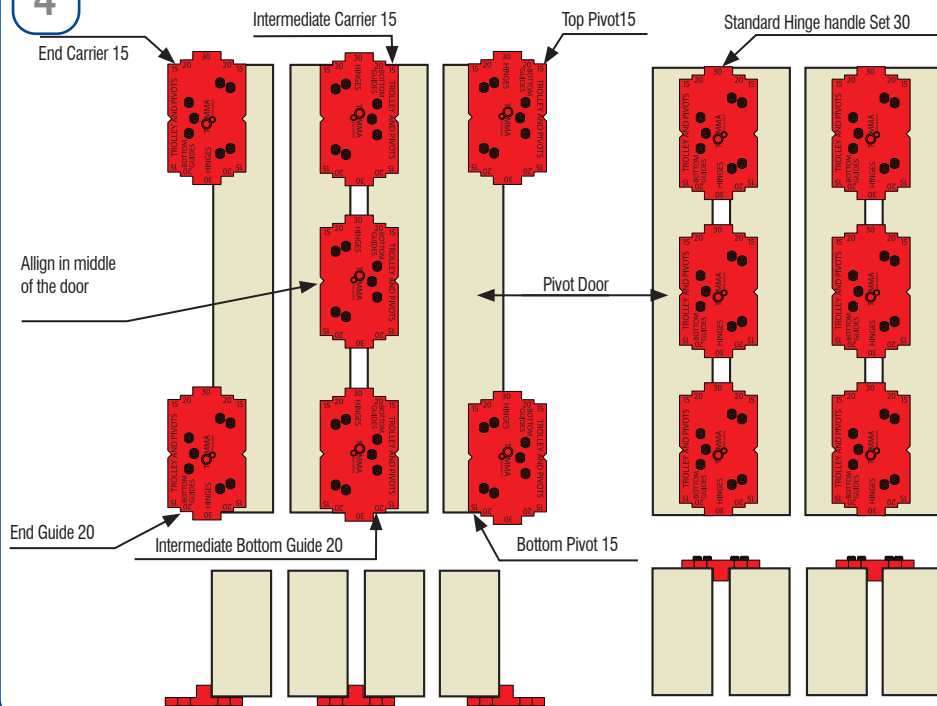

5

Place hardware in top and bottom track in correct order. (See optional track access section for loading and removing hardware on page 4)

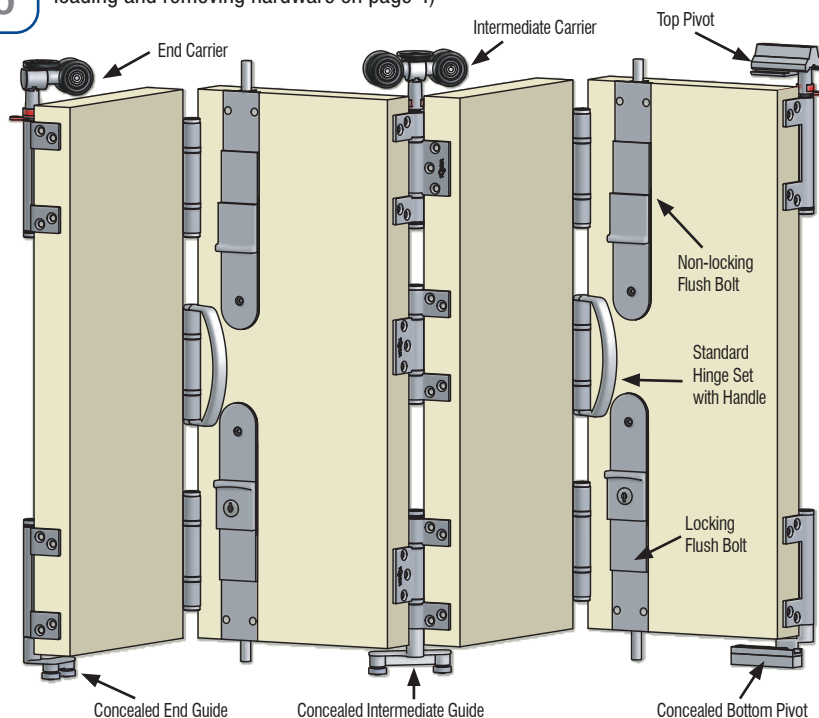

6

Mount bottom pivot hinge to bottom track

1. Disassemble pivot then place pivot base in bottom track.
2. Align the back edge of pivot base with the jamb (A)
3. Drill pilot holes using the base as a template and then fix with screws provided.
4. Fit gear wheel (B) and top plate (C) and fix with Hex drive cap screws (D)

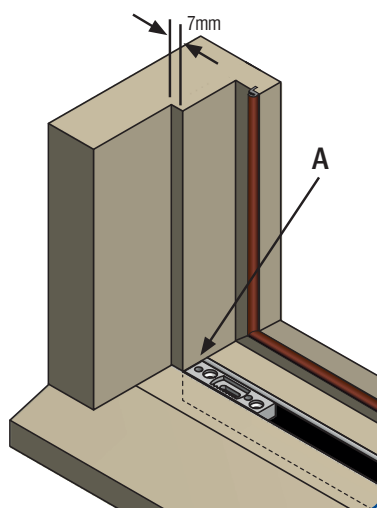

7

Fix bottom pivot hinge flap to jamb leaf using pre-drilled holes made in Step No.4, then place jamb leaf on bottom pivot pin and fix top pivot via pre-drilled holes made in Step No.4.

8

Adjust height of jamb leaf via top pivot.

Top Pivot

Tighten clamp to track via screws.

Loosen lock screw. (IMPORTANT - lock screw must face toward interior of property).

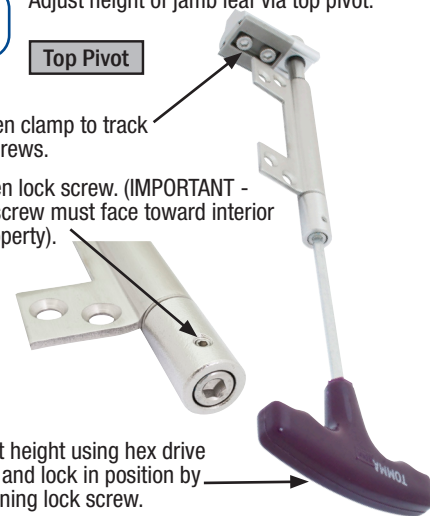

Adjust height using hex drive T-bar and lock in position by tightening lock screw.

9

Adjust plumb of jamb leaf via top or bottom pivot.

Concealed Bottom Pivot

Loosen screws and rotate gear to adjust level.

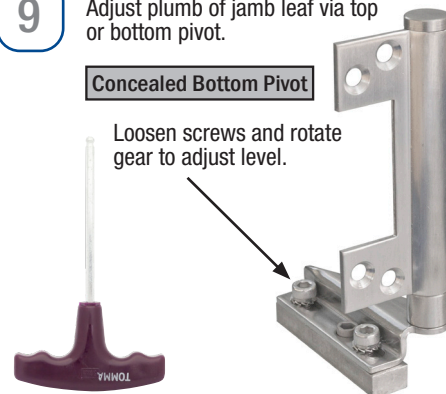

10

Fit hinge sets to next leaf to be mounted using pre-drilled holes made in Step No.4.

11

Fit this leaf to jamb leaf using pre-drilled holes made in Step No.4.

12

Depending on door configuration (eg if 3 or more leaves required on any side of door frame) continue to mount hardware and door leaves as shown in Step No.5.

13

Adjust intermediate, end or meeting carriers (if fitted) as shown below.

Carrier Sets

Loosen lock screw. (IMPORTANT - lock screw must face toward interior of property).

Adjust height using hex drive T-bar and lock in position by tightening lock screw.

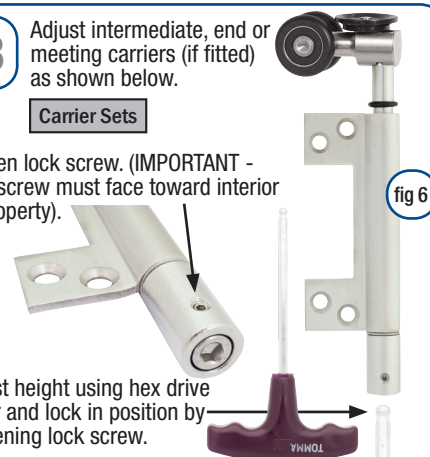

14

Mount flush bolts and accessories to doors, and flush bolt keeps to head and sill.

tommafold60®

Other options and working methods to consider during installation of Tommafold60.

Track Access Section (optional)

To make the loading and removal of components easier, and also for future maintenance, the upper track may be cut before installation as shown below to allow a removable section 100mm in length to act as an access point. It is then simply screwed back in place after installation or maintenance is completed.

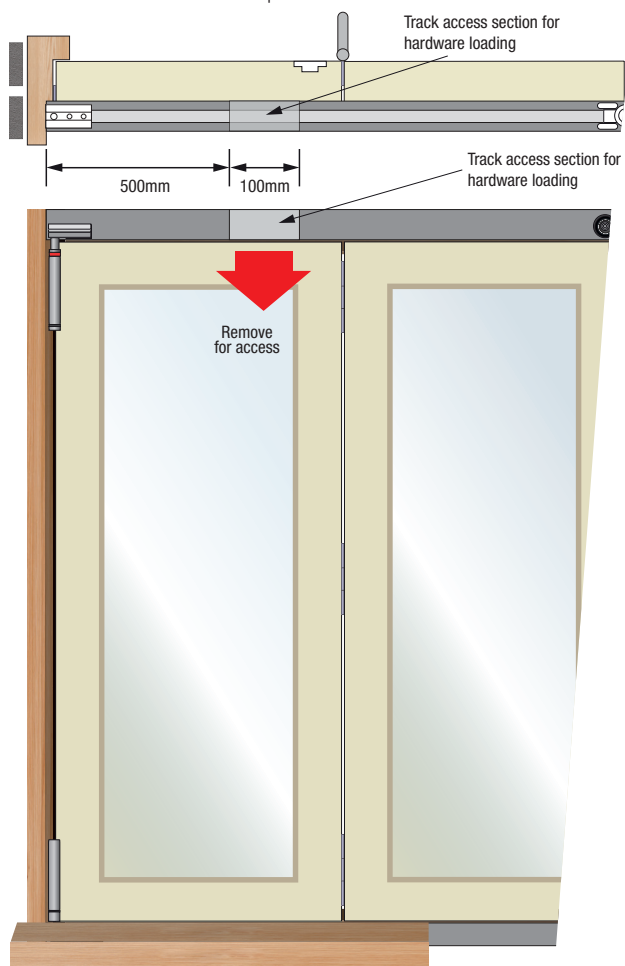

Security Hinge (optional)

Optional central hinge increases security and prevents door movement and warping. This is used at the jamb in conjunction with the pivot set. Only available in Satin Stainless Steel

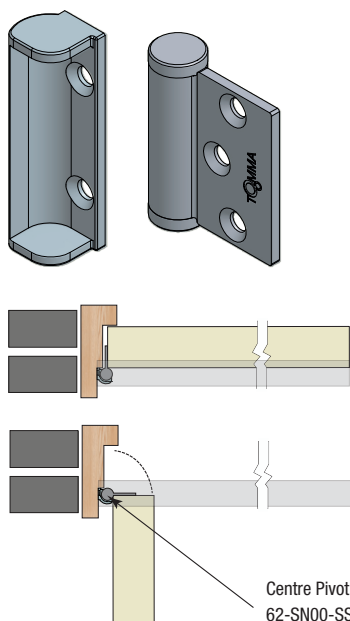

Part No.	Finish
62-SN00-SS	Satin Stainless

Additional weather sealing options

Rebated Doors (optional)

Not recommended for doors under 45mm in thickness.

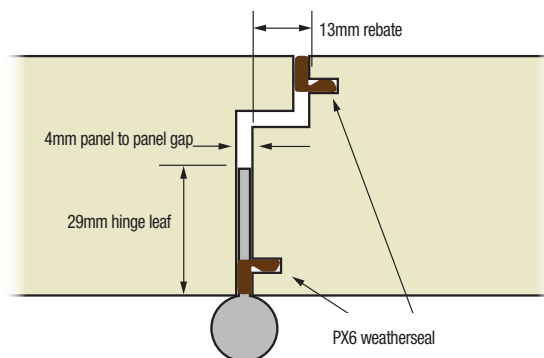

Tommafold Bottom Seal (optional)

(outward opening configurations only)

This is a useful addition which greatly reduces the possibility of water and debris entering the bottom guide channel on outward opening configurations.

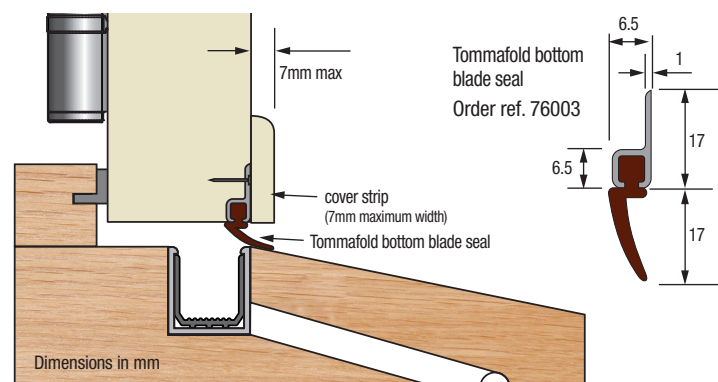

Threshold Sealing Bar (optional)

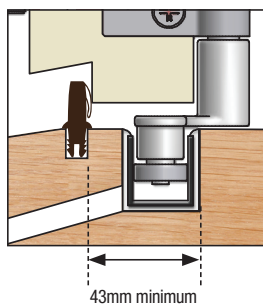

Weathersealing on inward opening configurations can be improved further by using a Threshold Sealing Bar and rebating the bottom edge of the door as illustrated on the left. Colour: Brown

Part No.	Length
GSP 410	914mm
GSP 411	2400mm
GSP 412	3000mm

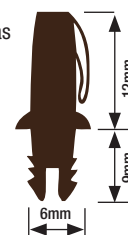

Track Draining Tube Kit (optional)

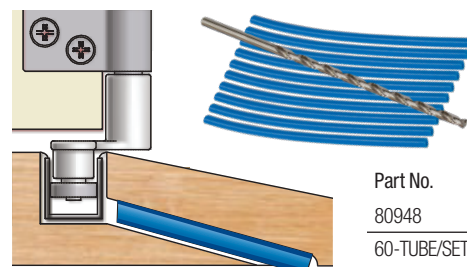

Use to line drainage holes in wooden sills to prevent rotting of timber.

Part No.	Item
80948	HSS Drill Bit 8 x 240mm
60-TUBE/SET	Set of 10 tubes 8 x 200mm

Runners Sliding Door Systems
Signal Hill
Lenborough Road
Gawcott
Buckingham
MK18 4BU

UK & Europe Sales:
Tel: 00 44 (0)1280 822288
Fax: 00 44 (0)1280 813024
Email: sales@runners-sales.com
Web: www.runners-uk.com
www.tommafold.com

