

Pivora - Pocket Door System Installation Guide

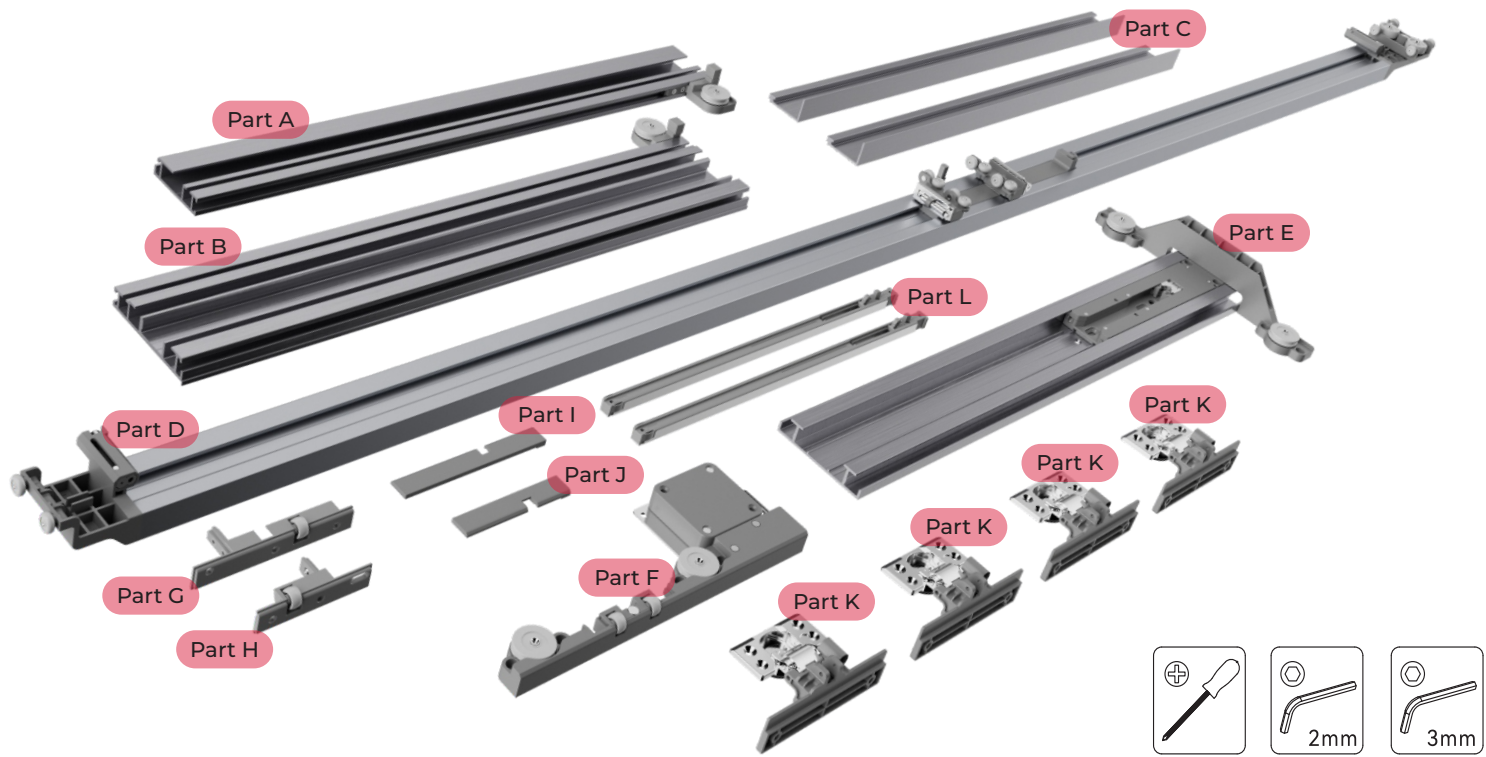

Installation Options

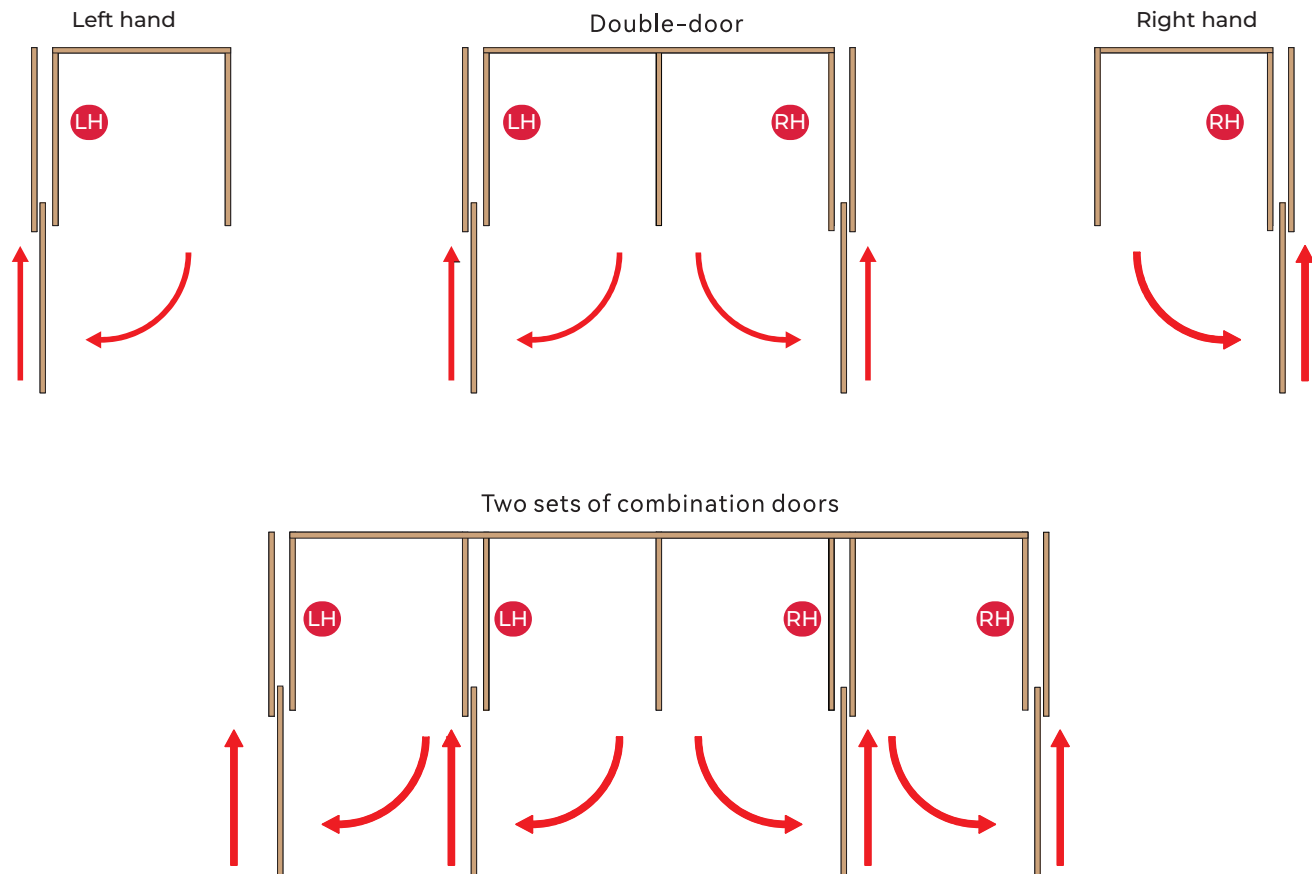

1 Installation parameter

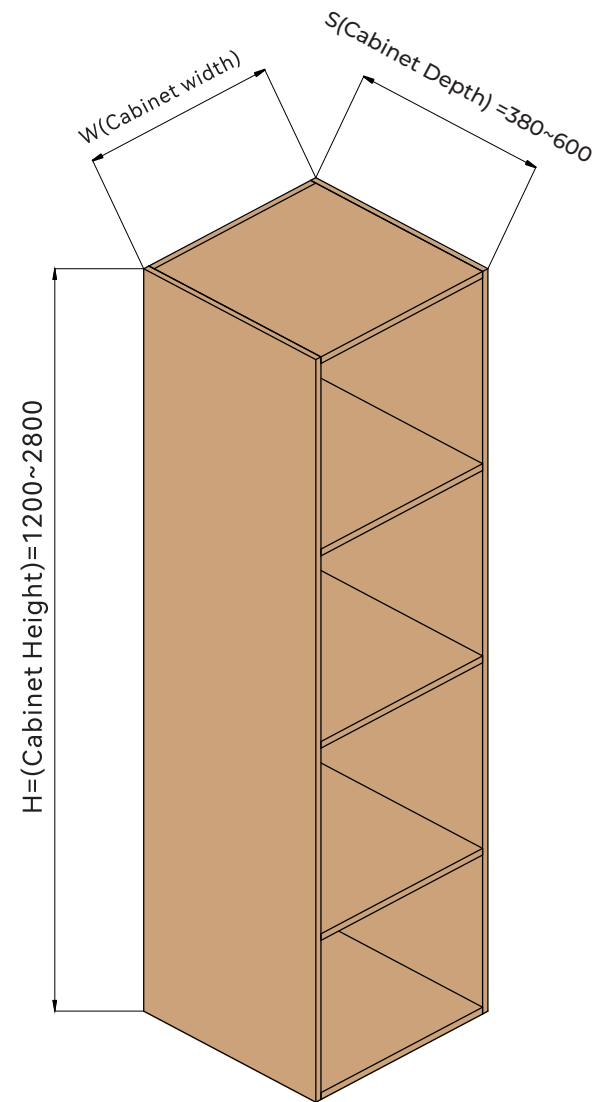

Abbr	Description	Abbr	Description
W	Cabinet width	H1	Middle rail position
W1	Cabinet with side sealing plate width	H2	vertical rail cutting Height
S	Cabinet depth	DW	Door width
S1	Middle rail Width	DS	The width of the door panel when the door panel is flush with the side panel
S2	Side sealing plate Width	DH	Door Height
S3	Pre-drilled hole distance of the side guiding wheel	C	Side sealing plate thickness
S4	Side guide connector aluminum width	T	Door thickness
H	Cabinet Height		

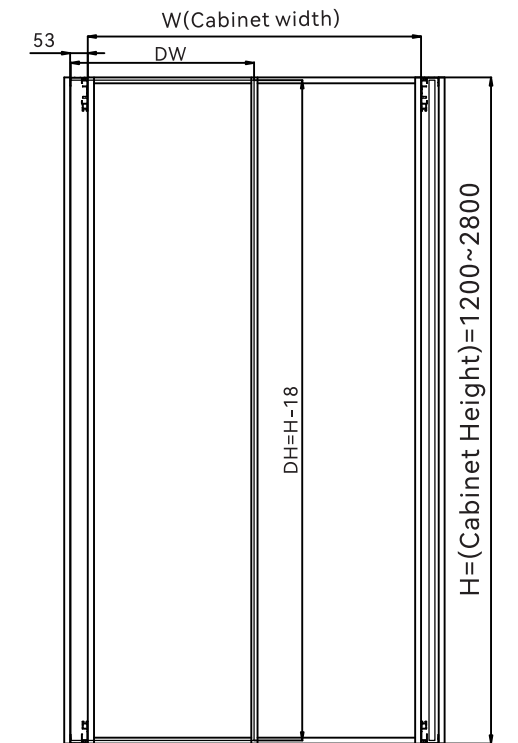

Door Panel Flush Side Panel

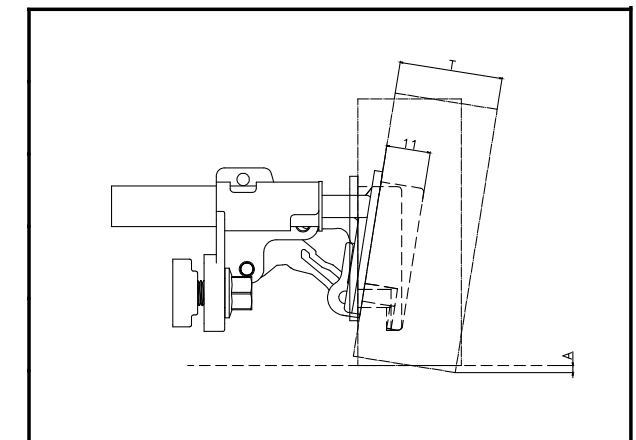
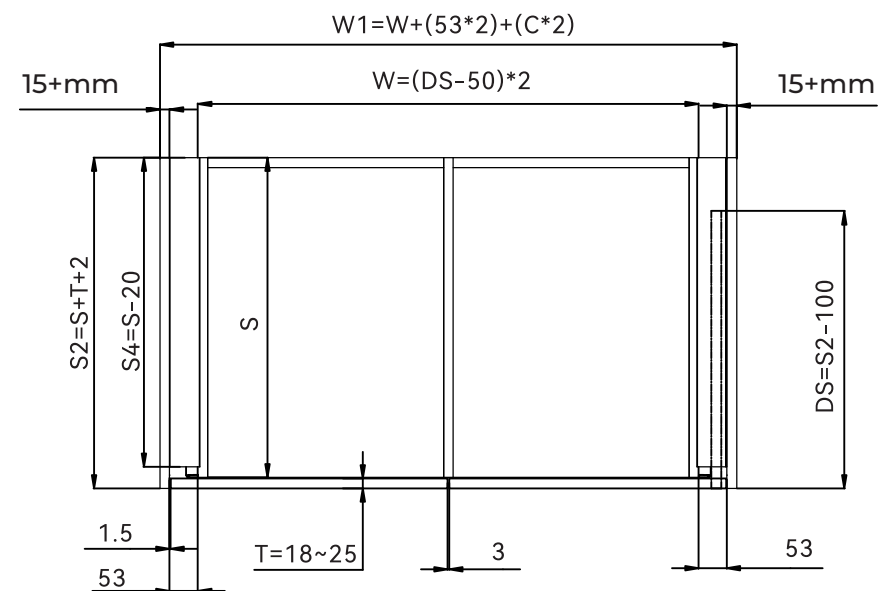

Opening Clearance Value

		T=18	T=19	T=20	T=21	T=22	T=23	T=24	T=25
A	K=4	0	0	0	0.1	0.2	0.3	0.3	0.4
	K=5	0	0	0	0	0.1	0.2	0.2	0.3
	K=6	0	0	0	0	0.1	0.2	0.2	0.3
	K=7	0	0	0	0	0.1	0.2	0.2	0.3
	K=8	0	0	0	0	0.1	0.2	0.2	0.3

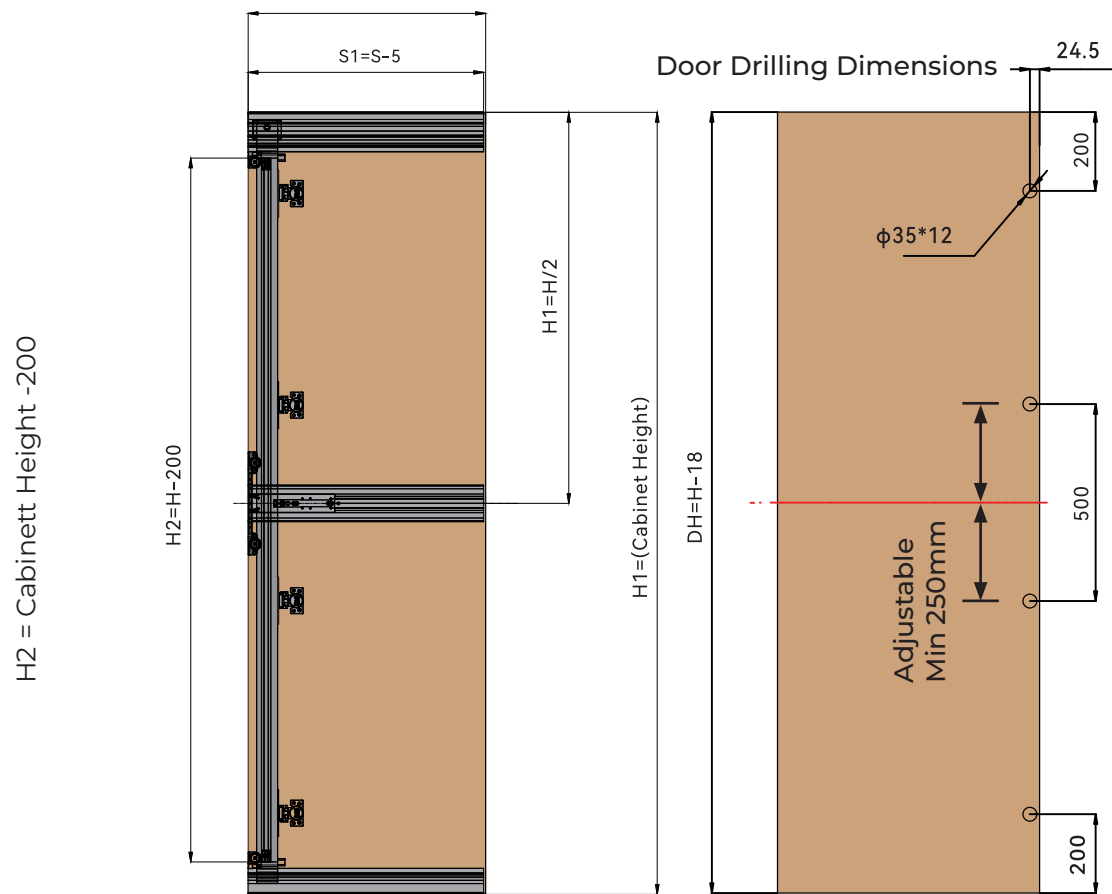

Door Panel Flush Side Panel

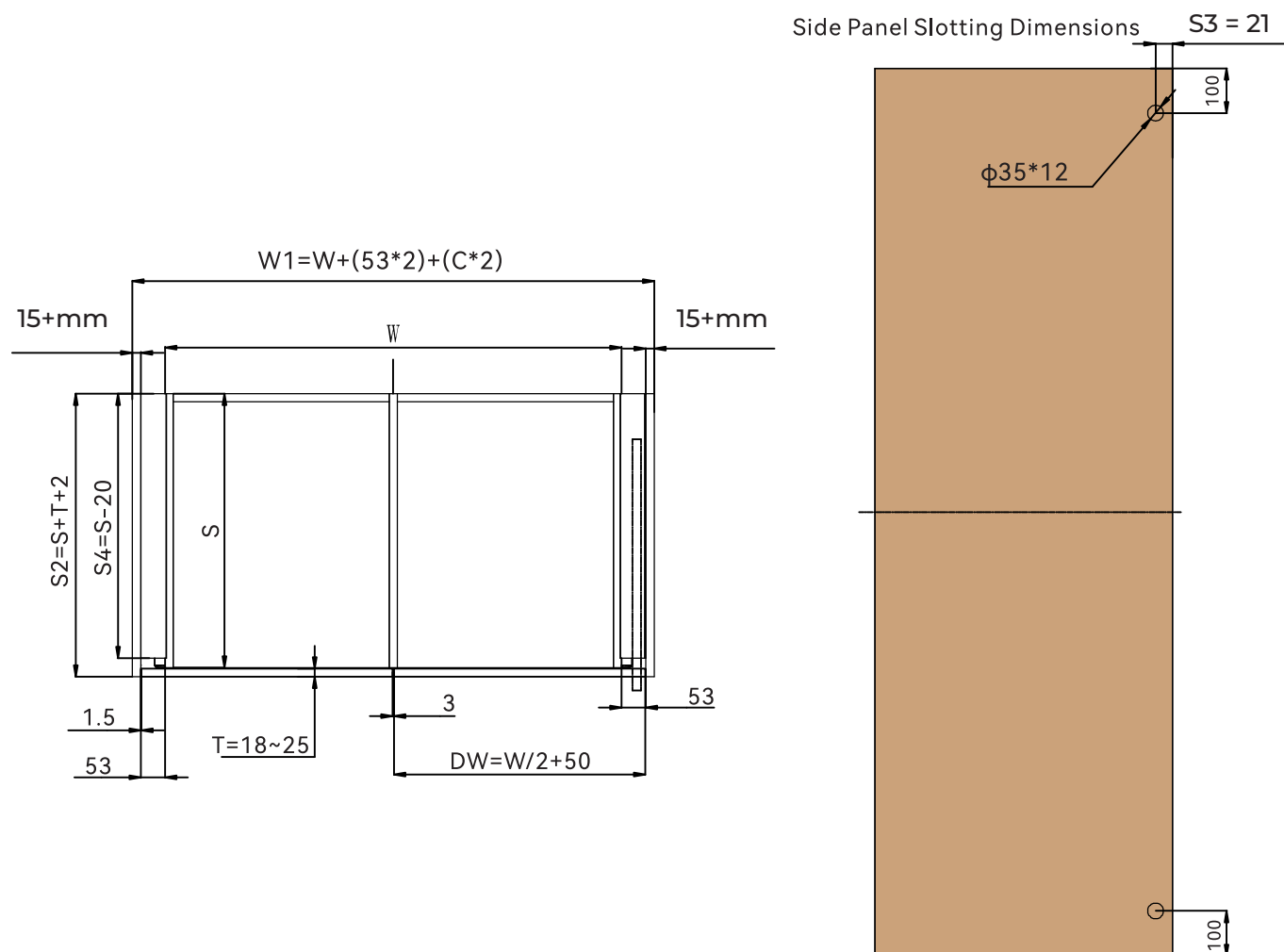

2 Cutting rail

2.1 Cut the top, middle and bottom rails as well as the side cover plates according to the depth of the cabinet.

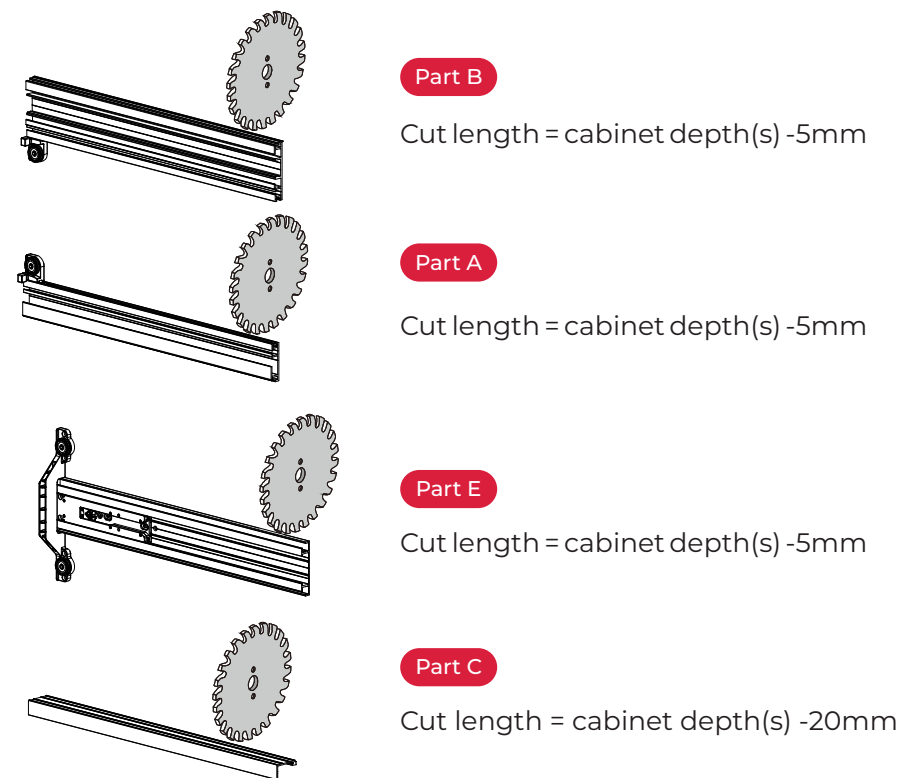

2.2 Cut the vertical rail according to the height of the cabinet.

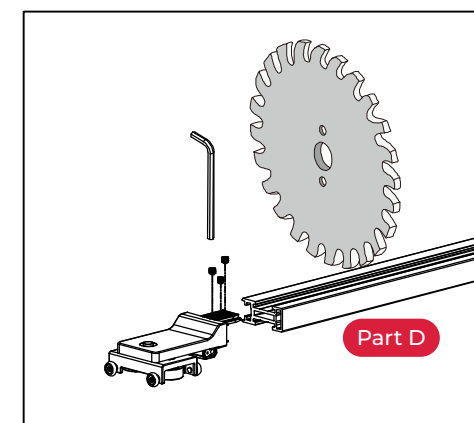

Step 1
Cut length = Cabinet height -200mm

Step 2
Loosen one side of the pulley assembly with a 3mm Allen Key.

Step 3
Cut the aluminium.

Step 4
Place the pulley assembly back into position and lock it.

Step 5
Clean the inside of the rail after cutting the aluminium to prevent dust from effecting the product experience.

3 Installation procedure

- 3.1 - Fix the upper rail assembly, using 4 x116mm screws
 - Top edge of the profile should be flush with the top edge of the carcass
 - Screw heads must not protrude
- 3.2 - Fix the middle rail assembly, using 4 x116mm screws
 - Middle edge of the profile should be central to the height of the cabinet
 - Screw heads must not protrude
- 3.3 - Fix the bottom rail assembly, using 4 x116mm screws
 - The down edge of the profile should be flush to the bottom of the cabinet
 - Screw heads must not protrude

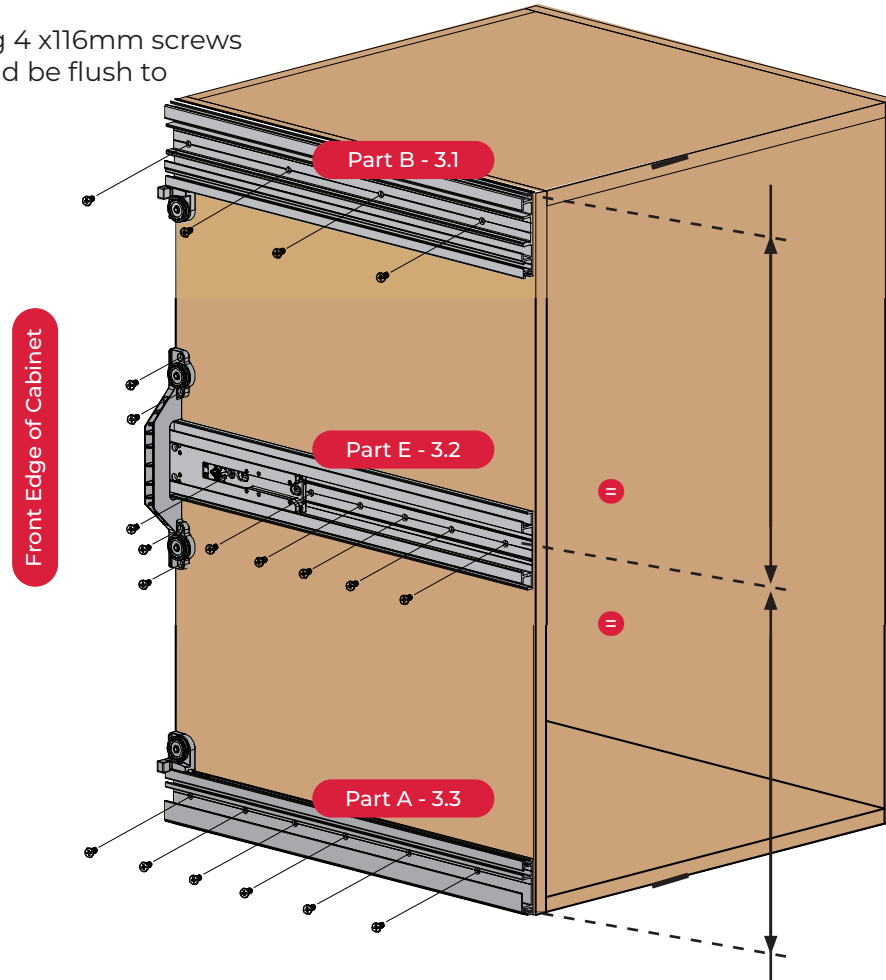

3.4- Align the profile handle assembly section with the rail.

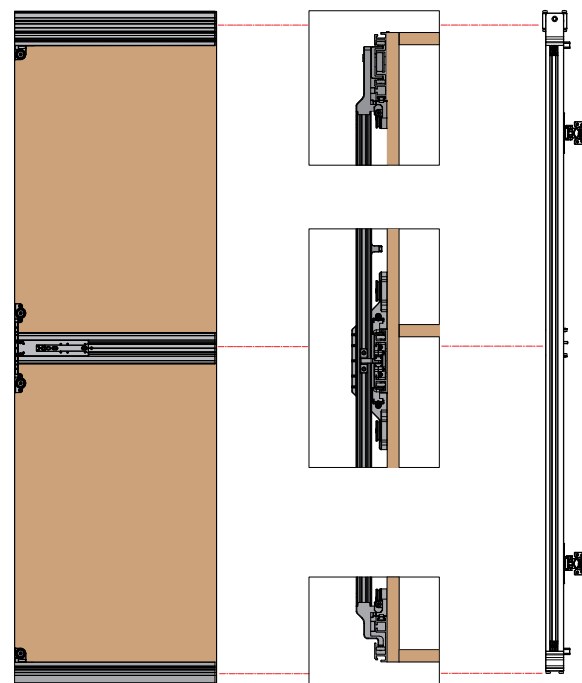

3.5- Push the profile handle assembly to the bottom of the middle rail, press then lock it.

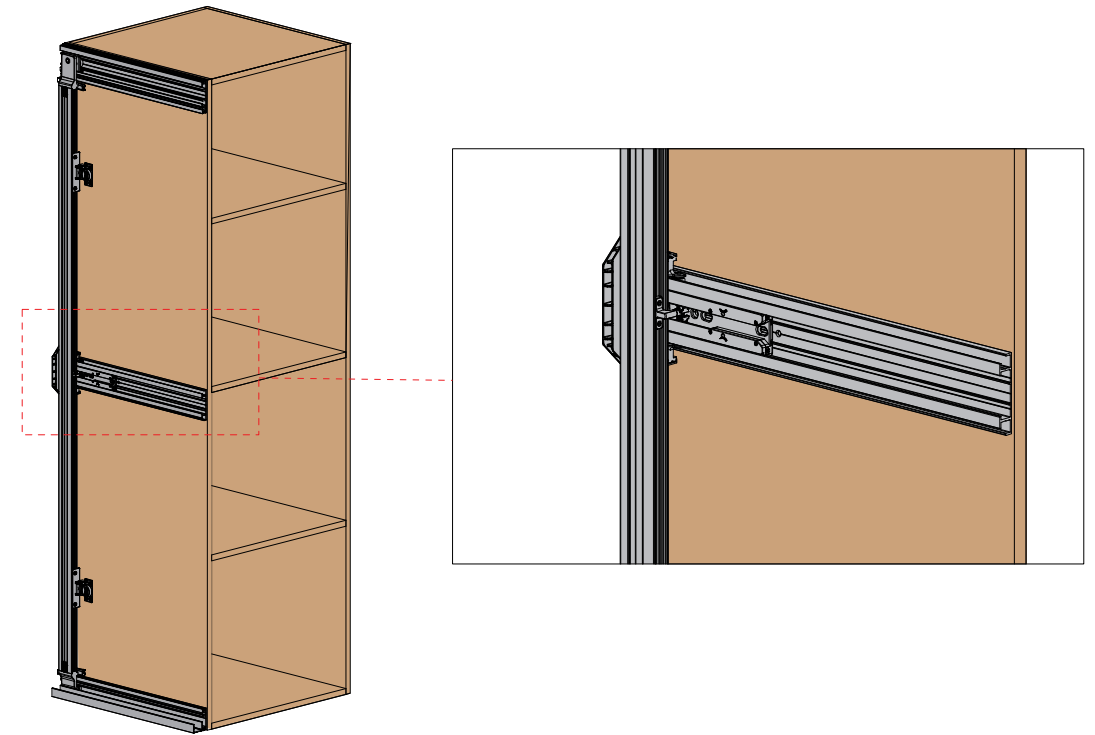

3.6- Install the damper in top and bottom rail.

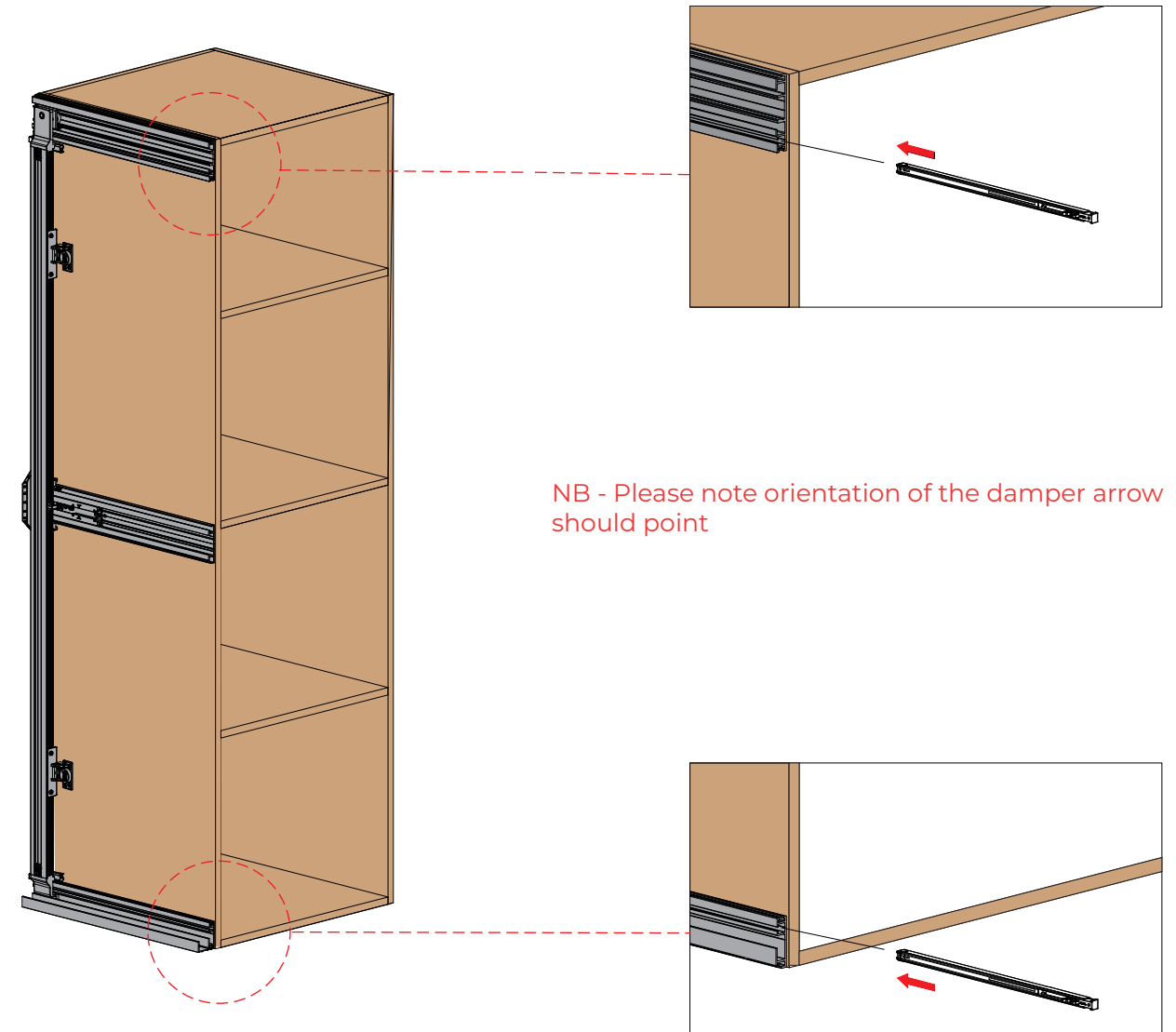

3.4- Align the profile handle assembly section with the rail.

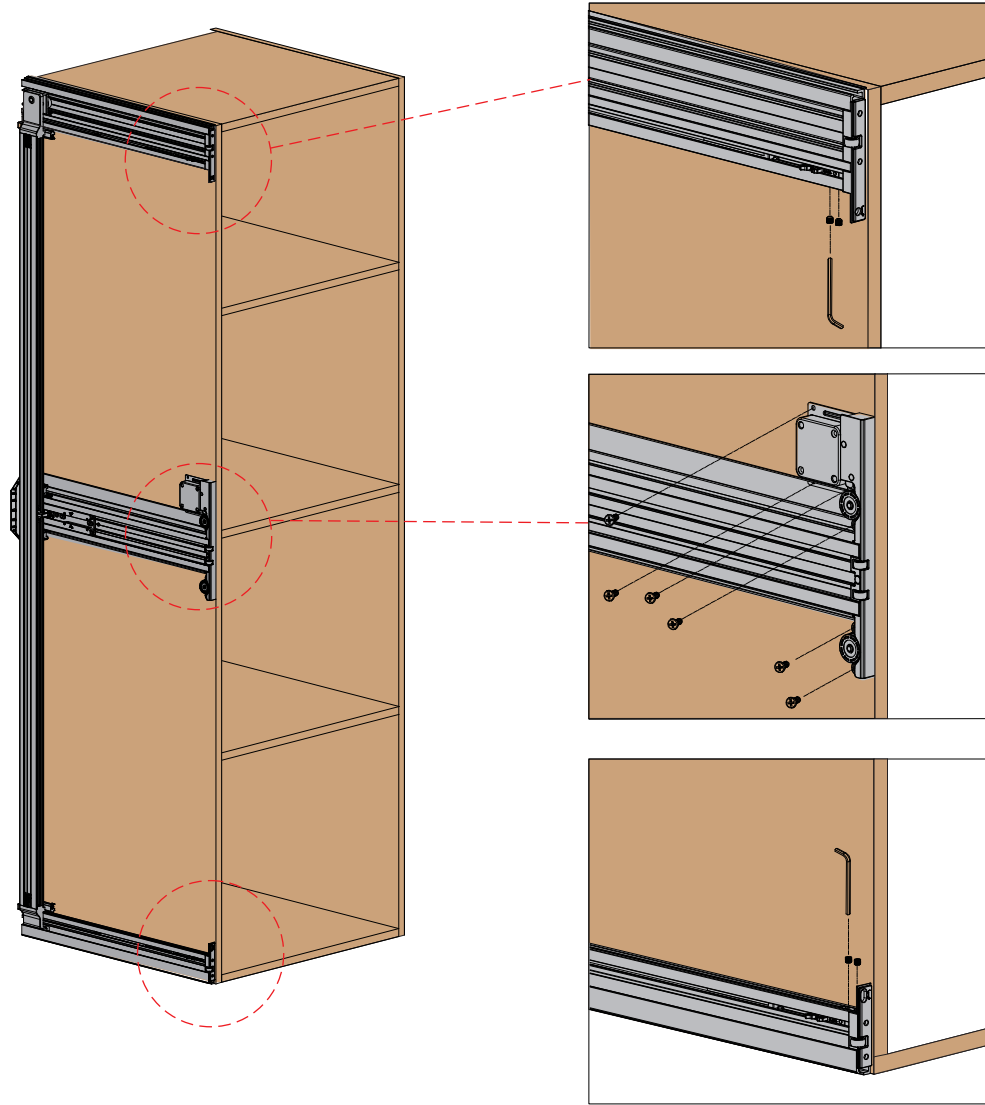

Use a 3mm allen key to lock the soft close in position.

Fix rear spring mechanism with 4 x 16mm screws provided.

Use a 3mm allen key to lock the soft close in position.

5 Install Door panel

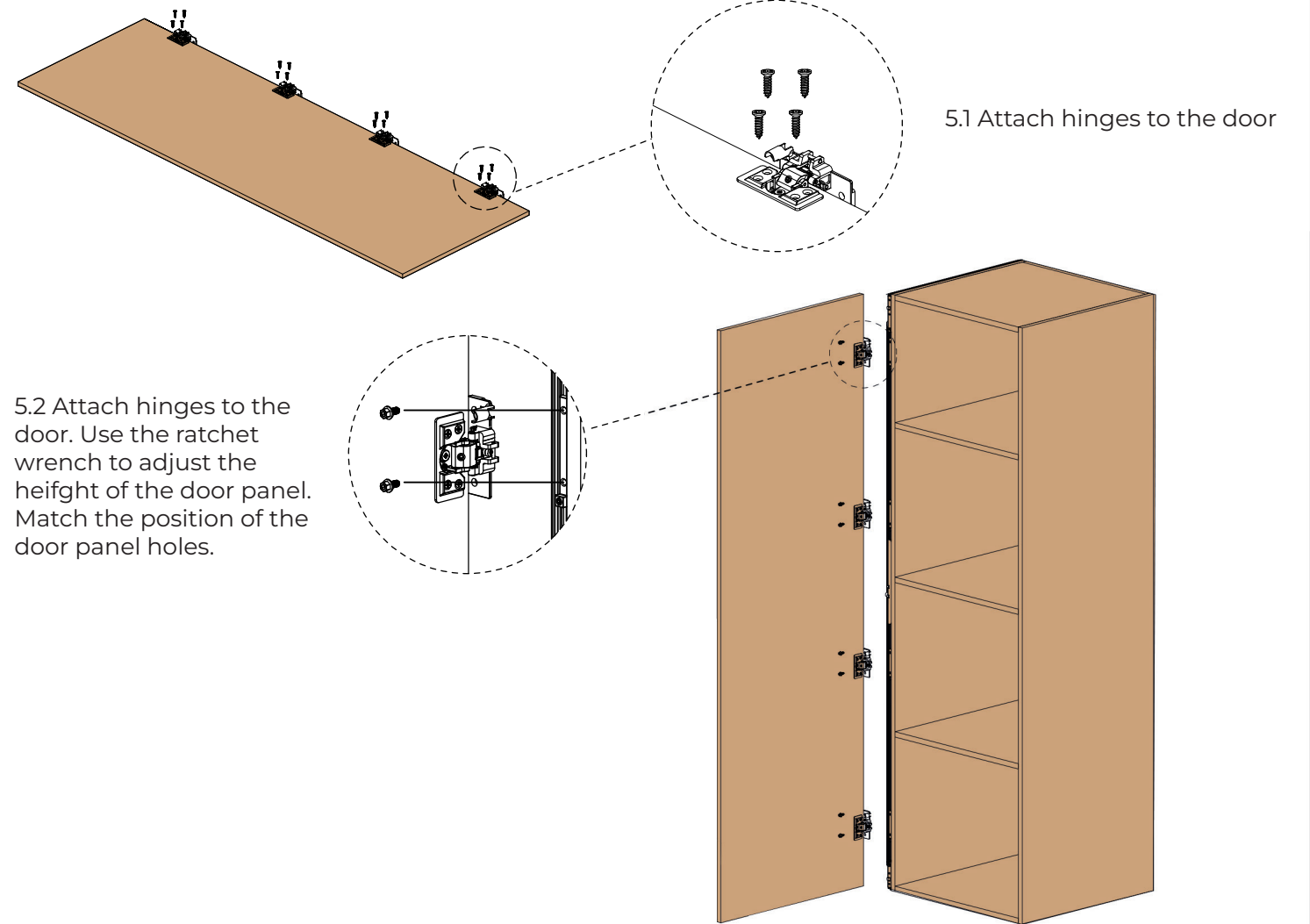

5.1 Attach hinges to the door

5.2 Attach hinges to the door. Use the ratchet wrench to adjust the height of the door panel. Match the position of the door panel holes.

4 Install wire Assembly and Fixed damper

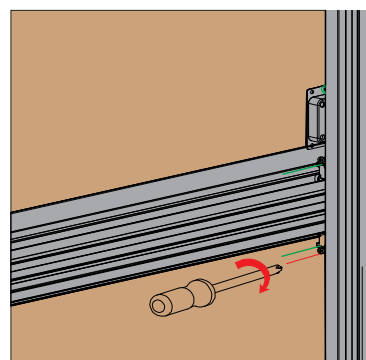
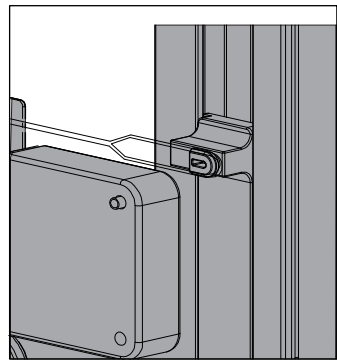

1 Loop one end of the tensioning wire around the assembly hook.

2 Pass the tensioning wire around the rear guide wheels.

3 Pass the wire over the top edge of the front guide wheel.

4 Tension with the locking screw, and cut off the excess steel wire.

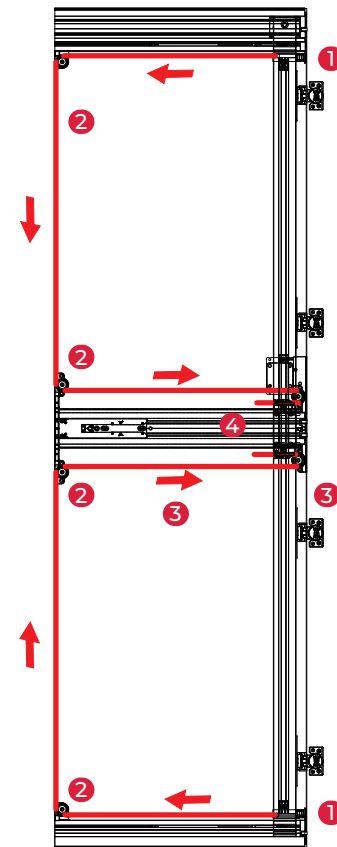

6 Door gap adjustment

6.1 With the buffer in a loose position, the door panel is pushed in and the buffer is pushed out, and the buffer is held in place with 2mm hex wrench

Same methods to fix the down damper

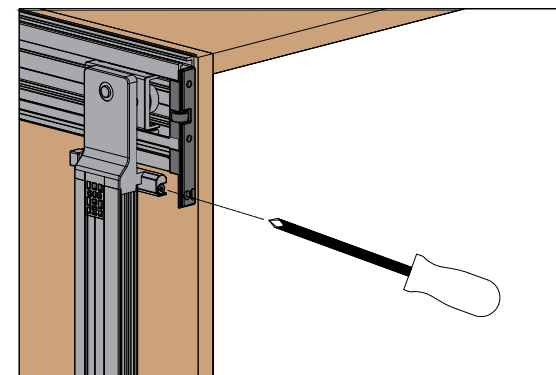
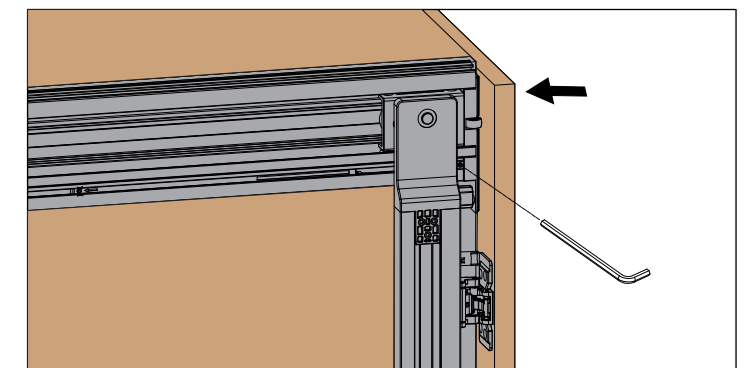

6.2 Adjustment of wire tension and door level by means of holes in the upper and lower guides.

7 Installation of decorative brushes

7.1 Measure the length of the brushes and cut them according to the L1/L2 lengths

7.2 Pull out the door panel, aluminum, brush and the brush panel, and then screw it in place

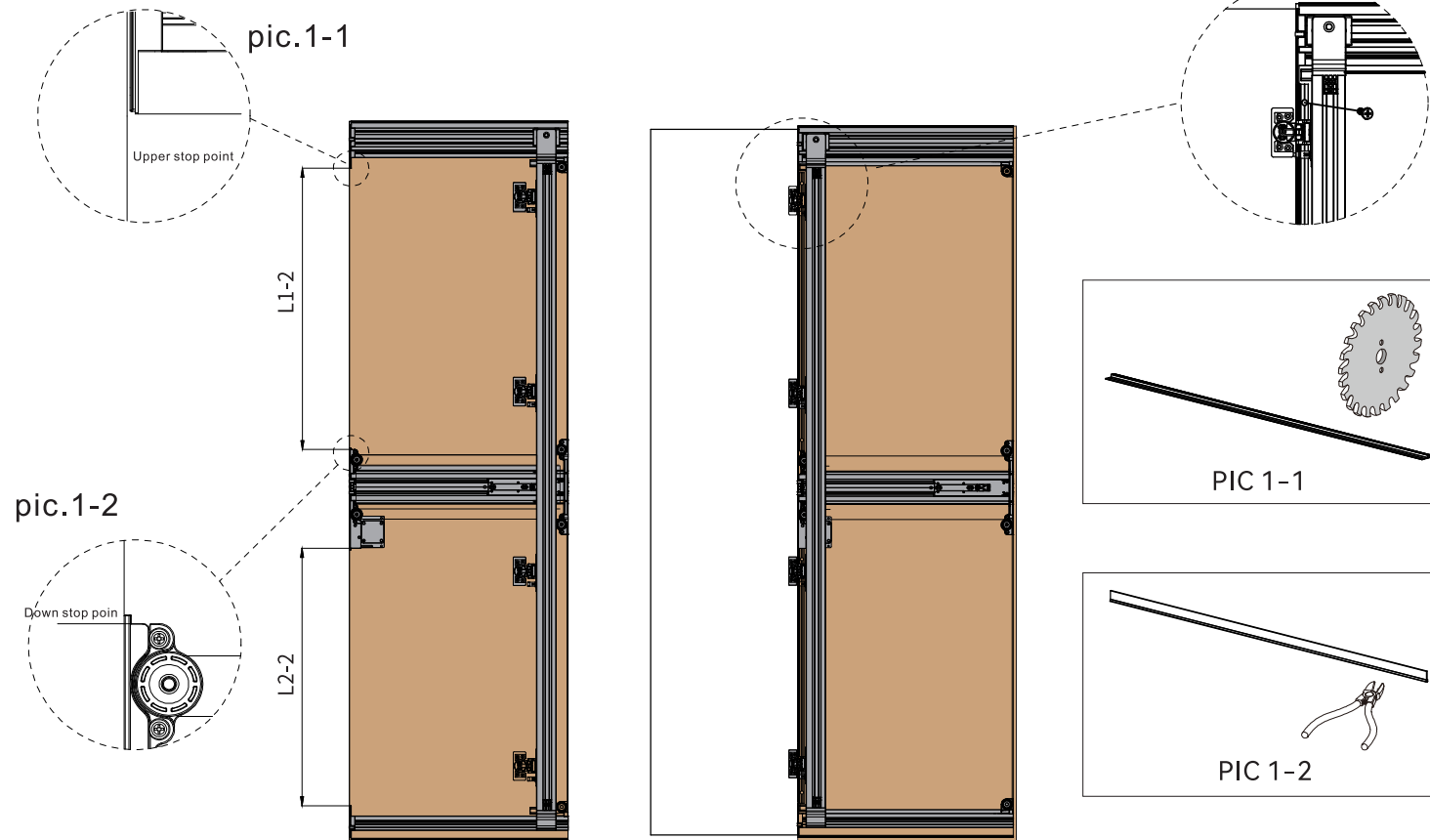

8 Installation of side guide wheels

8.1 Adjust the distance of the wheels according to the thickness of the door panel

8.2 Mounting the side guide wheels on the side panel

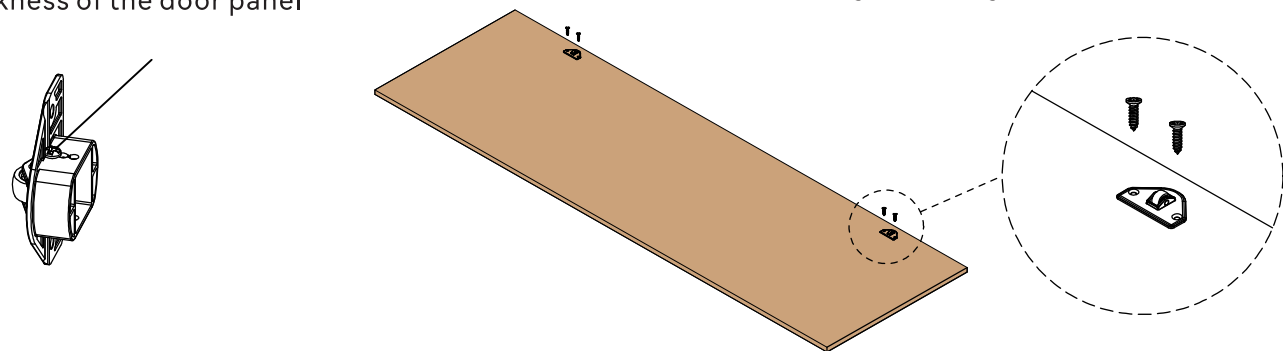

9 Installation of side sealing plate

The side sealer rail Assembly is fixed by ST4*16 cross countersunk screw, the screw head should not protrude (symmetry operation)

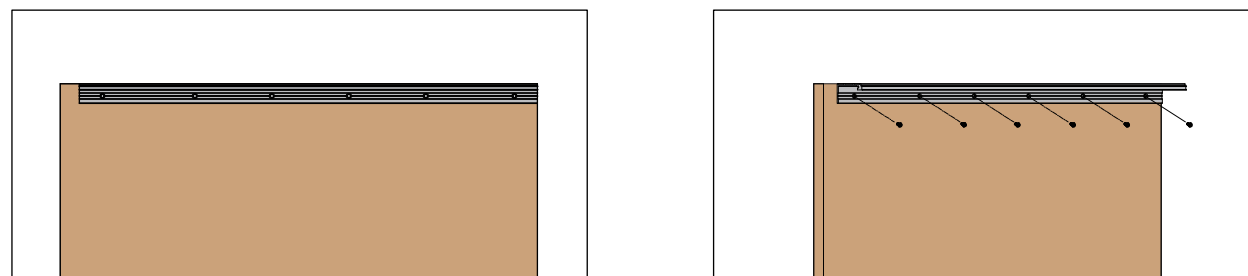

9.2 Slide the side panels onto the top and bottom rails and flush with the edge of the cabinet, locking them in place with socket head cap screws at the front and back



10 Door panel adjustment

10.1 Opening Angle adjustment: -8°

10.2 overlay adjustment: $\pm 2.5\text{mm}$

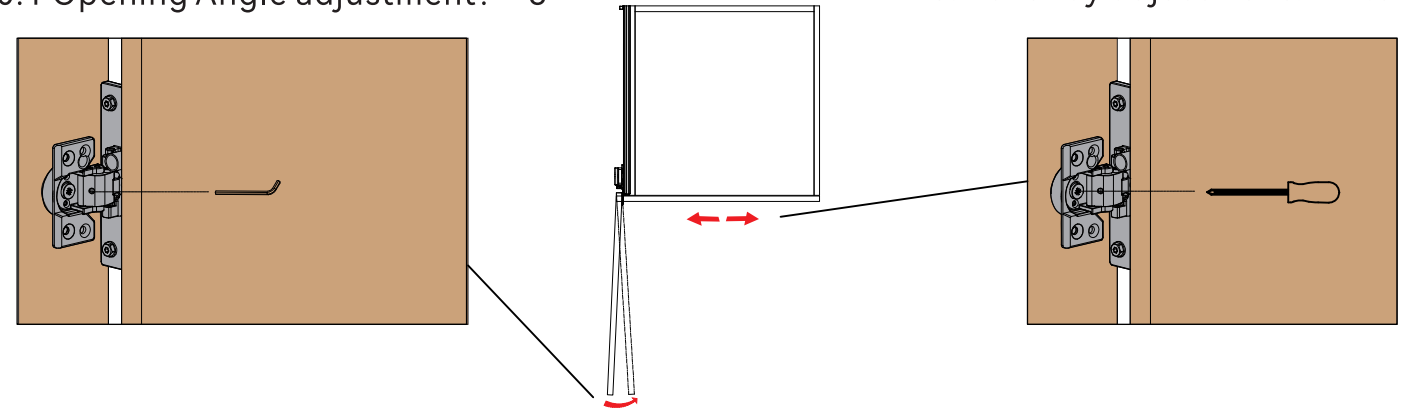

11 Installation of door stop buffer and cover

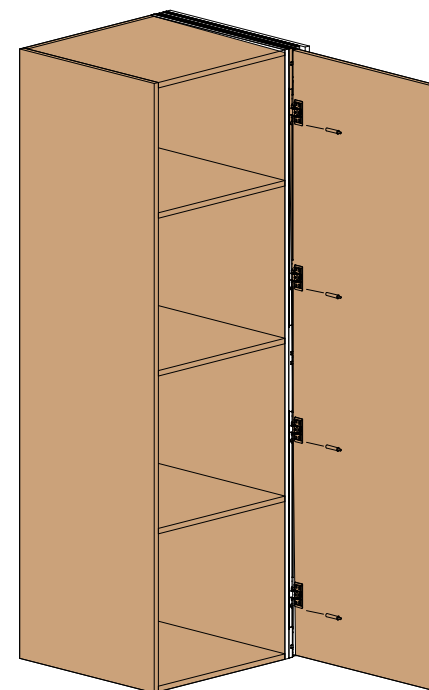

Install the door stop buffer

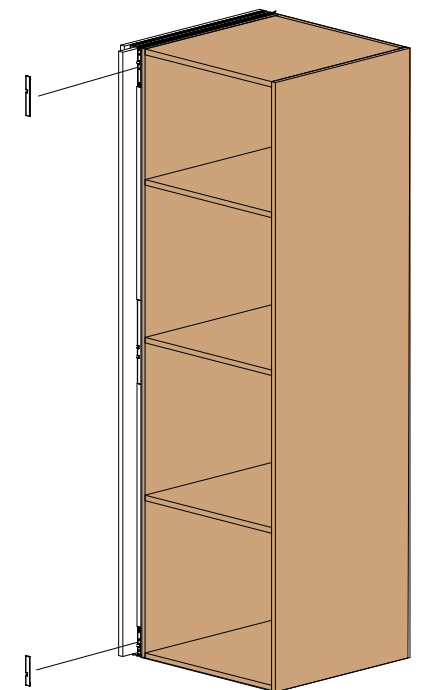

Install the cover

12 Installation of rebound buffer

Buffer base flush with panel edgelock with screws

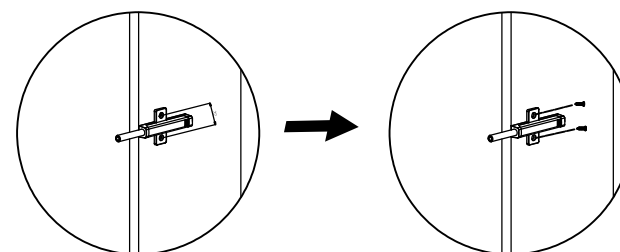

13 Application scenario

With handle design

Without handle design

